

CB612B
BALANCING
WIRING CENTRE
WITH WI-FI AP



QUICK GUIDE

Manufacturer:
SALUS Controls plc
Units 8-10, Northfield Business Park,
Forge Way, Parkgate Rotherham, S60 1SD, UK

Importer:
Salep Controls
European Distribution sp.z o.o. ul. Szamocka 8,
piętro 6. 01 748 Warszawa, Poland

UK: tech@salus-tech.com
DE: info@salus-controls.de
PL: poland@saluscontrols.com
FR: technicalsupport@saluscontrols.fr
RO: tehnic@saluscontrols.ro
DK: Support@salus-controls.dk



www.saluscontrols.com

SALUS Controls is a member of the Computime Group. Maintaining a policy of continuous product development SALUS Controls plc reserve the right to change specification, design and materials of products listed in this brochure without prior notice.

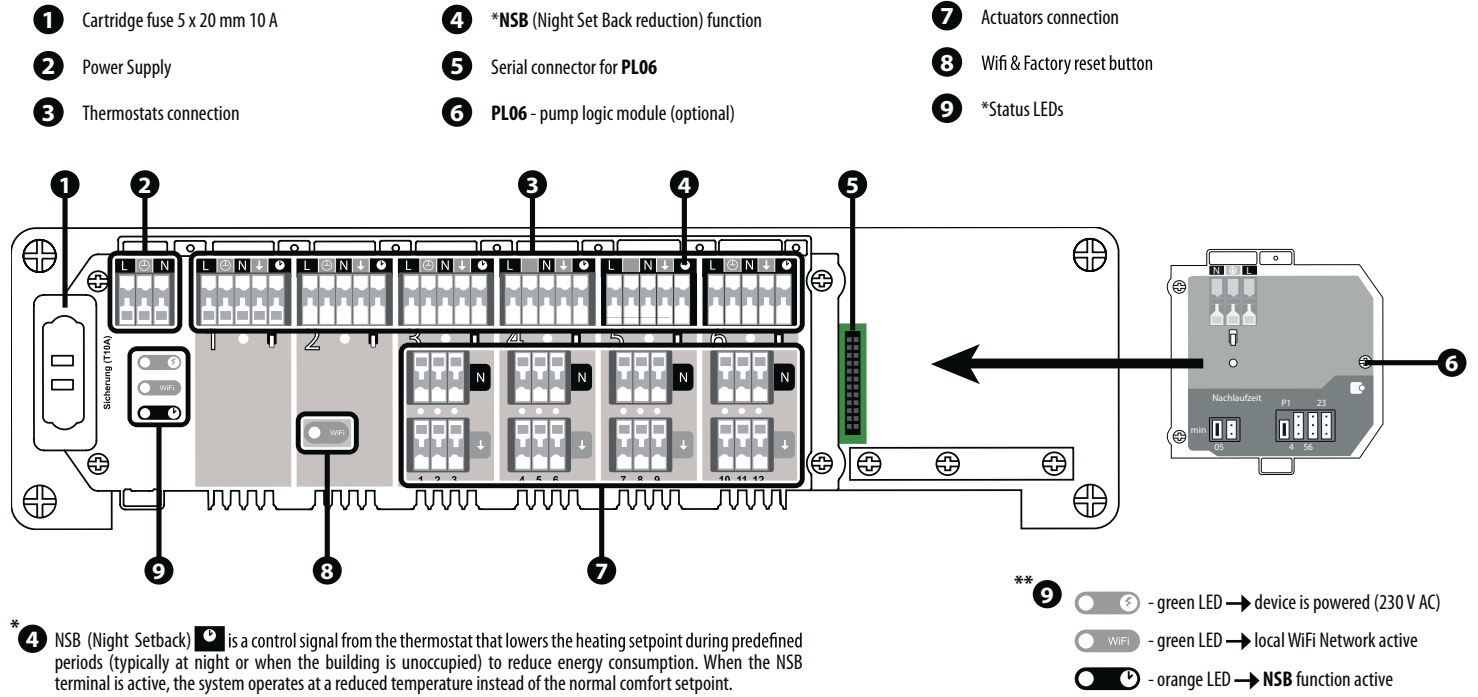

Introduction

The CB612B Balancing Wiring Centre brings smarter control to multi-zone heating systems. Its intelligent balancing algorithm optimizes heat distribution by limiting how many actuators operate at the same time, improving comfort and system efficiency. Compatible with SPAN and TPI/ITLC thermostats, the CB612B offers both Classical and Balancing modes, helping to protect the system, reduce wear, and ensure reliable long-term performance.

Product Compliance

This product complies with the essential requirements and other relevant provisions of Directives GPSR 2023/988, RED 2025/138, SVHC 251 (REACH) and RoHS 2015/863 and 2017/2102 amending Annex II to Directive 2011/65/EU of the European Parliament and of the Council on the restriction of the use of certain hazardous substances in electrical and electronic equipment. The full text of the EU Declaration of Conformity is available at the following internet address: www.saluslegal.com.
(P) 2405-2480MHz, <20dBm

Safety Information

Use in accordance to national and EU regulations. Use the device as intended, keeping it in dry condition. Product for indoor use only. Installation must be carried out by a qualified person in accordance to national and EU regulations.

Compatibility

This product is compatible with a wide range of devices, including thermostats, actuators, and the optional PL06 pump logic module, ensuring flexible and reliable system integration.

Box Content

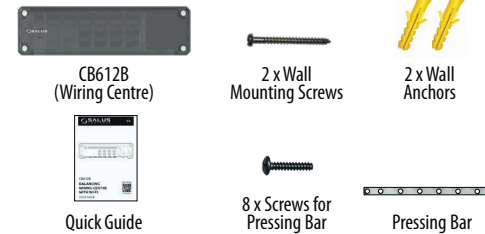

Installation

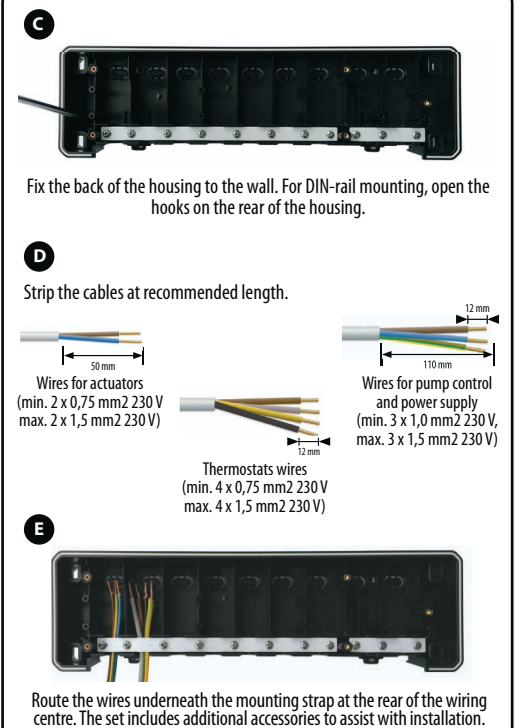
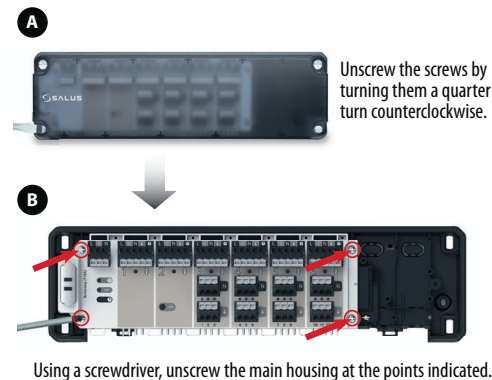

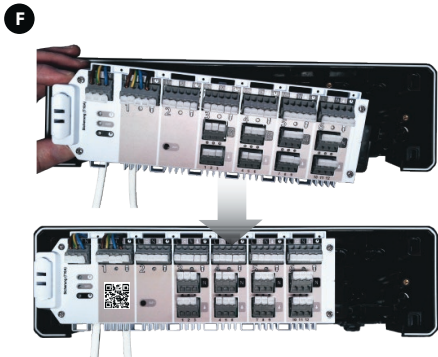

Route the wires through the top slots of the wiring centre, then connect them to the appropriate terminals.

G Ensure both thermostats and the power cable are connected in accordance with the provided electrical installation diagrams.

G.1 Power cable connection

Power supply: 230 V ~ 50Hz.
Tree-wires installation in accordance with applicable regulations.

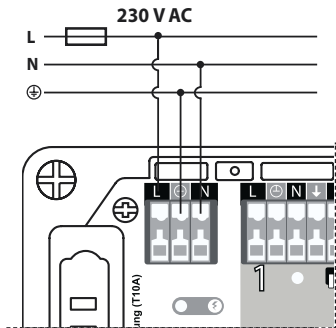

G.2 Power cable connection

Connection for VS30:

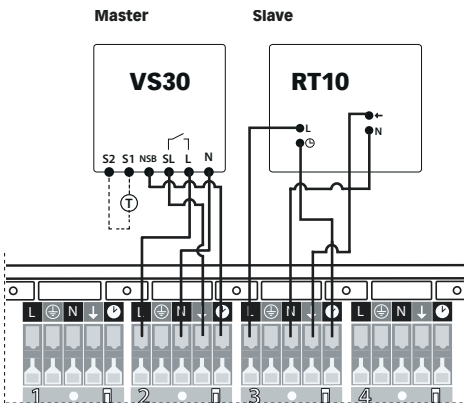

Connection for HTRP230:

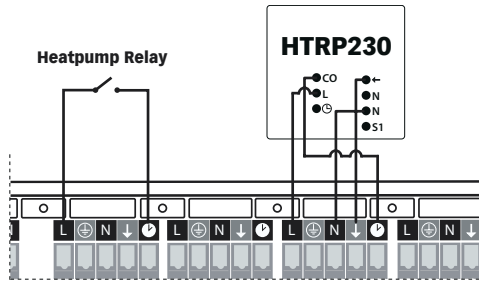

Arrange the wires, then secure the main housing of the wiring centre to the rear housing using the screws provided.

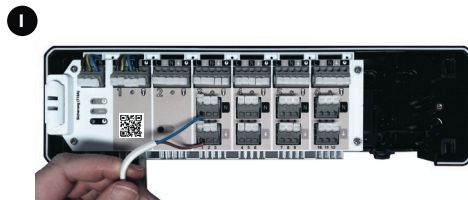

Connect the thermoelectric actuators wires as shown.

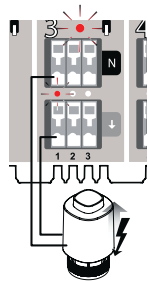

Secure actuator wires in the correct zone using the self-locking connectors. Up to 12 actuators can be connected.

↓ Active control
N Neutral



Check that all wires are securely connected, fit the top cover, and power up the wiring centre. The green Power LED will illuminate.

Installation of the additional module PL06

The PL06 module extends the functionality of the CB612B wiring centre by controlling the pump via the L / N / E connections. When there is no heat demand, the pump is switched off to reduce energy consumption.

A Connect the pump to the PL06 pump module by following the wiring diagram provided.

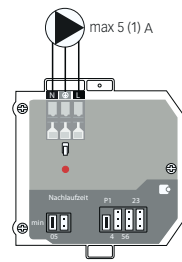

Power Supply: from the CB612B wiring centre
Max load: 5 (1) A
Dimensions [mm]: 80 x 80 x 20

B Connect the PL06 module to the serial connector.

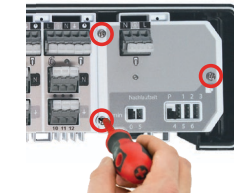

Note: Before connecting the PL06 module, disconnect the mains power supply to the CB612B wiring centre.

Programming

1 Connect the CB612B to the 230 V power supply. The green LED will illuminate to confirm power is on.

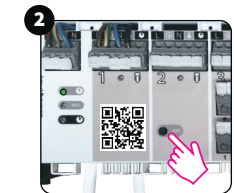
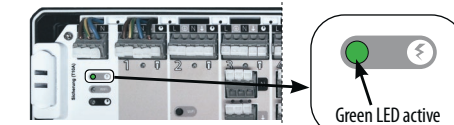

Press the „WiFi“ button until the green LED next to WiFi is solid green.

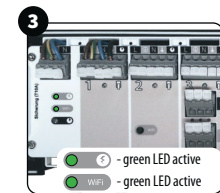

The CB612B is now sending a local WiFi signal (no internet connection)

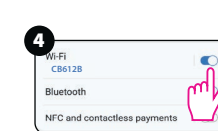

Activate the WiFi function on your smartphone and connect to the **CB612B - WiFi network**.



Scan the QR code on the **CB612B** next to the WiFi button or type in the address: <http://192.168.8.1>

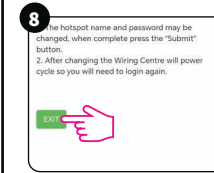
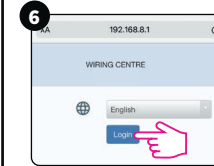

8 The hotspot name and password may be changed, when complete press the „Submit“ button.
2. After changing the Wiring Centre will power cycle so you will need to log again.



Screens 6, 7, and 8 are displayed when the user connects to Local Mode for the first time or when reconnecting after a factory reset. After submitting the Wi-Fi Hotspot settings, the device will reboot. The user will then need to log in again using the new password created on Screen 7.

Zones configuration and operating mode

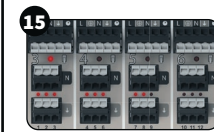
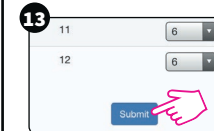
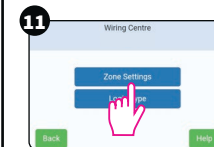
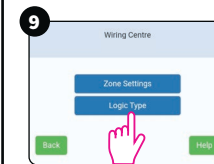

The active actuators are indicated with the red LED - while heating is on.

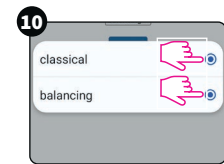

Select the operating mode. Default selected: **Classical**

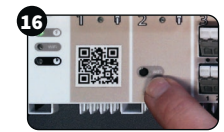
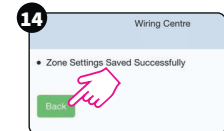

Close the local network, by pressing and holding the WiFi button until the WiFi LED turns off.

Factory reset

Press and hold the WiFi button for 10 seconds until the WiFi LED flashes rapidly. Release the button within 3 seconds to start the factory reset. The reset takes a few seconds and the WiFi LED will turn off when complete.

