



SIR600

SMART IR AC CONTROLLER



Installation Manual

MULTILANGUAGE
MANUAL



TABLE OF CONTENTS

Important Safety Information.....	4
Product Compliance.....	5
Box Content.....	5
Introduction.....	6
Key Features and Benefits.....	7
Product Specification.....	7
Overall Dimensions.....	9
Button Functions.....	9
LED Status & Colors	10
Setting up the Device.....	10
Choosing the Right Location.....	12
Mounting Procedure.....	14
App Setting Up and Operation.....	16
Setting Up the IR Remote From the App.....	17
Setting Up the Network Connection.....	30
Operating in Online Mode via the App.....	32
Factory Reset.....	34
Technical Data.....	35



Important Safety Information

- The product must be installed in compliance with any of the EU's regulations.
- The product must be stored in a safe dry area.
- Use the product the way it was destined to be used.
- The product was destined for indoor usage.
- To install and use the device correctly, please read all the instructions in this manual.
- Do not attempt to disassemble, repair, tamper with, or modify the product
- Disconnect your device before cleaning it with a dry cloth.

Box Content



SIR600



Wall Mounting Bracket



3M Tape



USB Cable



User Manual

Product Compliance

This product complies with the essential requirements and other relevant provisions of Directives 2014/53/EU and 2011/65/EU. The full text of the EU Declaration of Conformity is available at the following Internet address: www.saluslegal.com.

Introduction

Welcome to the user manual for the SIR600 (Smart IR AC Remote Controller) by SALUS. This innovative remote controller is designed to enhance your home comfort by allowing you to easily adjust the temperature of the air conditioning unit.

Whether you're seeking a cooler environment in the summer or a warmer atmosphere in the winter, the Smart IR AC Remote Controller provides a seamless and efficient solution. Aimed at providing a more comfortable and convenient living experience. This device integrates cutting-edge technology with user-friendly features, ensuring that you can enjoy the perfect indoor climate effortlessly.

This manual will guide you through a safe and easy installation of the device. It also includes instructions on how to operate and connect it to the App.

Key Features and Benefits

- WiFi connectivity with the *SALUS Smart Home Gateway*.
- The SIR600 has access to an online AC IR database, allowing for quick and easy identification and matching with your AC unit model.
- Supports AC control functions (depends on AC model) with user interface on the mobile app, including operating modes, heat/cool temperature setpoint, fan speed and swing.

Product Specification

This advanced controller supports hundreds of AC brands with infrared remotes, ensuring wide compatibility and effortless installation. With the SIR600, you can adjust your home's temperature remotely and synchronize heating and cooling for optimal comfort. Embrace the convenience and efficiency of modern smart home technology with the SIR600 Smart IR AC Controller, making your air conditioning system more intelligent and user-friendly.

**SALUS
PREMIUM**
Lite

Salus Cloud

UG Gateway



Smart
Premium App



Hydronic System Controls



AC Controls



Overall Dimensions



68mm

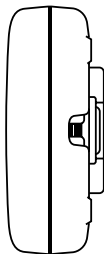

24mm

27mm

Button Functions







— Temperature **DOWN**

⏻ Power Toggle

+ Temperature **UP**

LED Status & Colours

Factory reset	
Standby mode (before pairing)	
Pairing (add SIR600 to the App)	
Pairing completion	LED OFF
IR Learning	
Change setpoint temperature or mode	

 - Solid LED light

 - Blinking LED light



Setting up the Device

In this chapter, you will learn how to power up and position your Smart IR AC Remote Controller for optimal performance. Proper setup is crucial for ensuring that the device communicates effectively with your air conditioner and integrates seamlessly into your home environment.

Follow these instructions to get your device up and running quickly, allowing you to take advantage of all its smart features.



An USB power adapter for the power supply will be required.



Retrieve the AC unit's IR code from the database.



The device shall be added into the Salus Smart Home system with the connection to the Salus UG gateway via the local WiFi network.

Choosing the right location

When installing your Smart IR AC Remote Controller, it's essential to position the device in a location that ensures effective communication with your air conditioner. Here are some key considerations to keep in mind:

- Start by placing the controller where it has a direct line of sight to your AC unit. This is important because IR signals require an unobstructed path to function correctly. Make sure there are no obstructions, such as furniture or walls, that could block the IR signals.
- Distance is also an important factor. Position the device within up to 10 meters of the AC unit for optimal performance. If the device is too far away, the IR signals may become weak and unreliable.
- To avoid interference, keep the controller away from reflective surfaces, which can scatter IR signals. Additionally, it's best to place it away from sources of electromagnetic interference, such as microwaves and routers, which could disrupt the device's performance. Direct sunlight can also affect the device, so try to position it away from windows where it might be exposed to harsh sunlight.

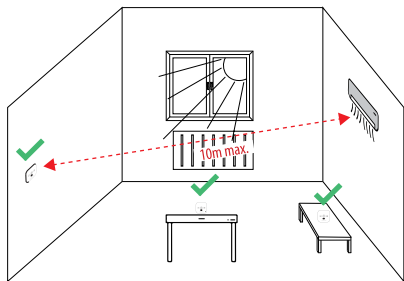
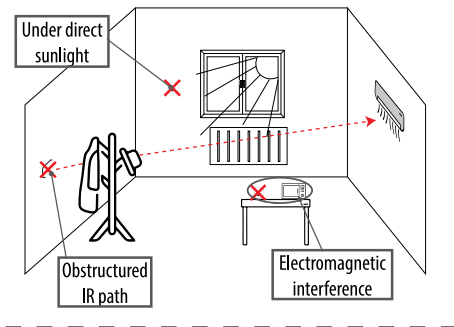

Mounting Procedure

- 1 Decide whether you want to mount the Smart IR AC Remote Controller on a wall or place it on a stable surface.
- 2 If it is opted for wall mounting, use the included mounting bracket to securely attach the device.
- 3 Start by marking the location where you want to install the device. Next, drill holes at the marked points, ensuring they are the correct size for the screws and wall anchors.
- 4 Finally, insert the screws through the mounting holes on the device and tighten them into the wall anchors until the device is secure.
- 5 If you prefer not to mount the device on a wall, simply place it on a flat, stable surface that provides a clear line of sight to your AC unit.

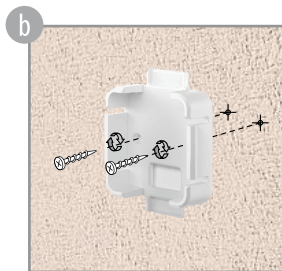
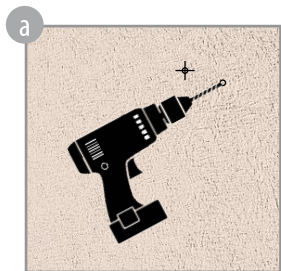

App Setting Up and Operation

First make sure that you have downloaded the SALUS Premium Lite App from the Google Play or App Store.



You will need to follow a few easy steps to create an account.



SALUS Smart Home Gateway is required for the installation of SIR600.

Please update the gateway to the latest software version before installing SIR600.



Setting Up the IR remote from the App

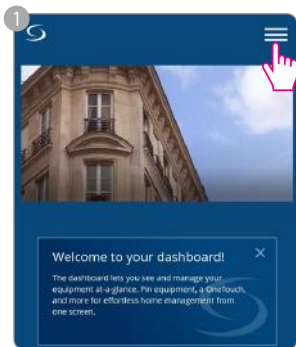

Select the **Menu** command from top-right corner to open the menu.

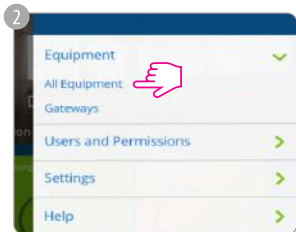

From **Equipment** category we select **All Equipment**.

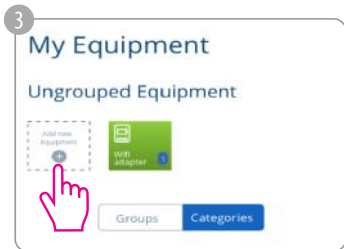

Here we select
**Add new
Equipment.**

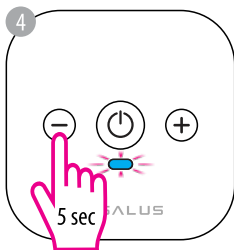

In order to prepare the
SIR600 for connection,
hold the button 
for 5 seconds.
**The blue LED will blink*

5

Welcome! Let's connect your equipment

Before trying to connect your equipment, please make sure they are ready to begin.

Scan for equipment



Scan for Smart IR AC Controller

1. Press the "-" button on the device for 5 seconds"
2. Click the "Scan for Smart IR AC Controller" button above. Your device will be found and appear on screen.

Select Scan for **Smart IR AC Controller** as the connection mode.

6

Let's connect your equipment

Check the box next to each piece of equipment you'd like to connect now.
Click "Connect equipment"



Infrared

Connect equipment

Cancel

If the scanning was successful the infrared device will be shown and we must select it.

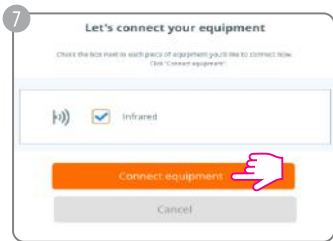

After selecting,
we will confirm
by choosing
**Connect
equipment.**

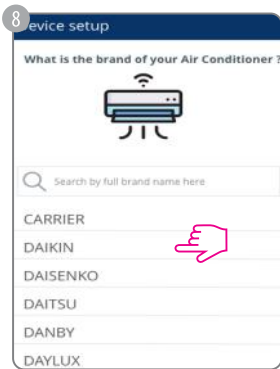

Search and select the
brand of the AC device.

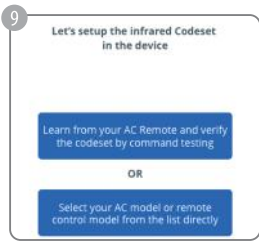

Once we selected the AC brand we have two options (*see the following pages*):

OPTION A

Program the device by capturing commands from your physical AC remote controller and test the commands to ensure they work correctly.

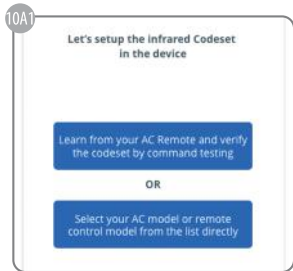

We select first option.

10A2

Let's capture an infrared signal from your AC remote

Place the remote in an appropriate position and
press the **POWER** key once for IR signal capturing.



Pointing on the Sakus logo
at a distance of **2-5cm**

If there is no **POWER** button on your remote control,
please press the **mode** button

The indications presented on
the screen must be properly
followed.

10A3

Notice

Great! We received the infrared signal.

Let's verify the IR codeset by few tests

OK



If the IR signal was detected,
the following notice will be
received. Press **OK**.

Let's do some tests to verify the Infrared codeset

Two different sets of IR command can be sent to the AC unit by the following buttons.

	A	B
Power	ON	OFF
Mode	COOL	COOL
Temperature	24°C	24°C
Fan Speed	AUTO	High
Swing	ON	ON

Please press the button and observe the changes of the status on the AC unit directly (do not read the original AC remote)

Are the commands working properly?



FIRST CODESET

Check if the commands work as shown. If they do, then select **YES**.

Let's do some tests to verify the Infrared codeset

Two different sets of IR command can be sent to the
AC unit by the following buttons.

	A	B
Power	ON	OFF
Mode	COOL	COOL
Temperature	25°C	25°C
Fan Speed	LOW	High
Swing	OFF	OFF

Please press the button and observe the
changes of the status on the AC unit directly
(do not read the original AC remote)

Are the commands working properly?



SECOND CODESET

Check if the commands work as shown. If they do, select **YES**.

10A6

Let's do some tests to verify the Infrared codeset

Two different sets of I command can be sent to the AC unit by the following buttons.

	A	B
Power	ON	OFF
Mode	COOL	COOL
Temperature	23°C	23°C
Fan Speed	LOW	AUTO
Swing	ON	OFF

Please press the button and observe the changes of the status on the AC unit directly (do not read the original AC remote)

Are the commands working properly?

YES

No

THIRD CODESET

Check if the commands work as shown. If they do, select **YES**.



If everything went accordingly, the following message should appear.



**SIR's blue LED light will be ON*

OPTION B

Program the device by selecting your AC model or remote control model from the list directly.

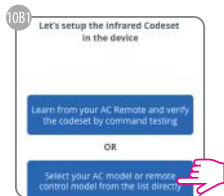

We select the second option.

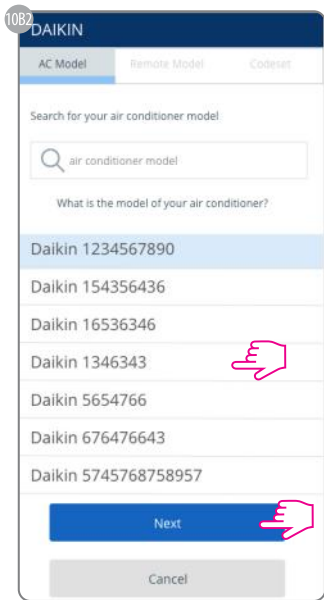

From the **AC Model** list, select the model of AC device.

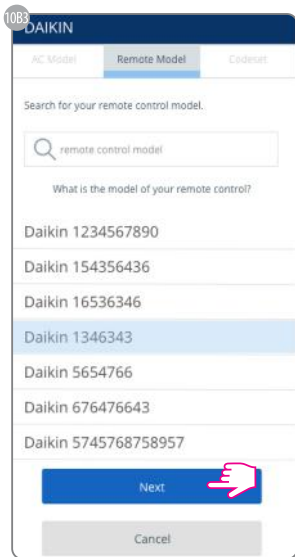

Then select the **Remote Model** list and select the model of AC remote. After selection, select **Next**.

10B4



Please note !

If you have obtained the suggestion on the codeset ID from our customer service for your AC unit, you can select it from the table shown in the list Codeset as shown. If no Codeset ID suggestion has been provided, this step can be ignored.

10A7



If everything went accordingly, the following message should appear.



**Blue LED light will be ON*

Setting up the network connection

In order for the IR and gateway to communicate, the WiFi Network must be configured.

Please note that if the mobile phone and the gateway are not in the same WiFi network, the application cannot access the properties of the device.

After following the previous steps it will require for the selection of the WiFi Network.



Select the desired network from the list.



Provide the password for the selected network and select **Provision**.

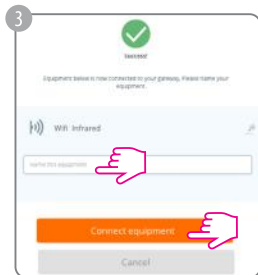

Name the new equipment and select **Connect Equipment** to confirm.

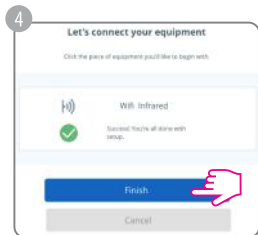

Select **Finish** to confirm.

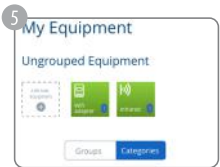

Device has been added and will be shown.

Operating in Online Mode via the App

This section will provide more info regarding all the features and setups that can be done in the operation of the SIR600.

Once the IR device has been connected via the SALUS Premium Lite App, we can now work on configurations and settings regarding the operation and functionality.



From the front page of the App we select the **IR AC Remote** icon.

From there we can turn on the AC while also setting the features.



Disclaimer: App features are dependant on the AC unit's features and options.

Factory reset

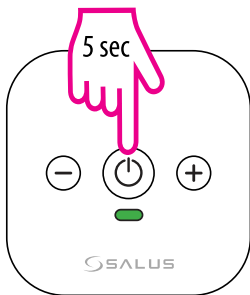

In order to realize a factory reset on your device you must press and hold the power button  for 5 seconds.

**Green LED light will stay ON for 5 seconds.*

Technical Data

Input	5Vdc 1A by USB-C
Connectivity	WiFi 2.4GHz
AC modes	Auto, Cool, Dry, Fan and Heat (Depending on the AC model)
Swing	Supports only vertical swing and up to 7 positions
Fan Speed	Auto and 1 - 7 (Depending on the AC model)
Storage temperature	-10°C to 50°C, <90% RH
Operating temperature	-0°C to 40°C, 5-90% RH, non-condensing
Dimensions (H x W x D)	68mm x 68mm x 27mm

SALUS Controls
Units 8-10, Northfield Business
Park, Forge Way,
Parkgate, Rotherham, S60 1SD,
United Kingdom

Email: sales@salus-tech.com

SALUS Controls GmbH,
Dieselstrasse 34,
63165 Mühlheim am Main,
Germany



www.saluscontrols.com



SALUS Controls is a member of the Computime Group
Maintaining a policy of continuous product development SALUS Controls plc
reserves the right to change specifications, design and materials of products listed
in this brochure without prior notice.

V02
11/2024

