

091PRO RF
PROGRAMMABLE THERMOSTAT



MULTILINGUAL
MANUAL

Quick Guide



SALUS Controls plc,
Units 8-10,
Northfield Business Park,
Forge Way, Parkgate
Rotherham, S60 1SD

SALUS Controls GmbH,
Dieselstrasse 34,
63165 Mühlheim am Main,
Germany

UK: tech@salus-tech.com
DE / NL: info@salus-controls.de
FR: technicalsupport@saluscontrols.fr
RO: tehnic@saluscontrols.ro
DK: Support@salus-controls.dk



www.saluscontrols.com

SALUS Controls is a member of the Computime Group
Maintaining a policy of continuous product development SALUS
Controls plc reserves the right to change specifications, design and
materials of products listed in this brochure without prior notice.



V01
02/2025

Introduction

The 091FLv2 / 091FLRFv2 is a programmable weekly controller designed to regulate the temperature of heating or cooling systems. Before using the device for the first time, please read these instructions carefully. Use only AA, 1.5V alkaline batteries to power the controller. Insert the batteries into the compartment located under the flap. Rechargeable batteries are not allowed.

Product Compliance

This product complies with the essential requirements and other relevant provisions of Directives:
091FLv2: 2014/30/EU, 2014/35/EU, 2011/65/EU
091FLRFv2: 2011/65/EU, 2014/53/EU 868.0 MHz - 868.6 MHz; <13dBm
The full text of the EU Declaration of Conformity is available at the following internet address: www.saluslegal.com
(P) 2405-2480MHz, <14dBm

Safety Information

Use in accordance to national and EU regulations. Use the device as intended, keeping it in dry condition. Product for indoor use only. Installation must be carried out by a qualified person in accordance to national and EU regulations.

Box Content



Buttons & description

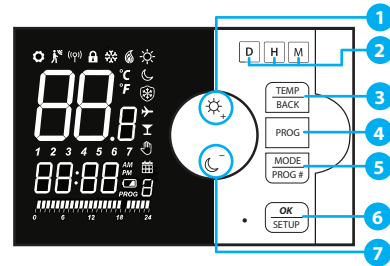

- 1. Setting **Comfort** or Temperature **UP**
- 2. Set the day (D), hour (H) and day (D)
- 3. Set **Comfort** or **Economy** temperature
- 4. Weekly Program setting.
- 5. **New Program Mode** or **Program Selection**
- 6. **Confirm function** or **Service Menu**
- 7. Setting **Economic Mode** or Temperature **DOWN**

Icons and Display

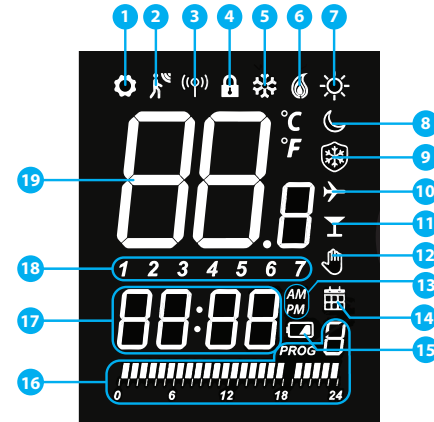

- 1. Settings
- 2. Motion detection
- 3. RF Status
- 4. Child protection
- 5. Cooling Mode
- 6. Heating Mode
- 7. Comfort Mode
- 8. Economic Mode
- 9. Frost protection Mode
- 10. Holiday mode
- 11. Party mode
- 12. Manual mode or Temporary override
- 13. AM / PM
- 14. Program mode icon
- 15. Low battery indicator
- 16. Program timeline indicator
- 17. Clock
- 18. Day of the week
- 19. Room or Setpoint temperature

Wiring Diagram

Refer to the wiring diagrams for proper receiver installation.

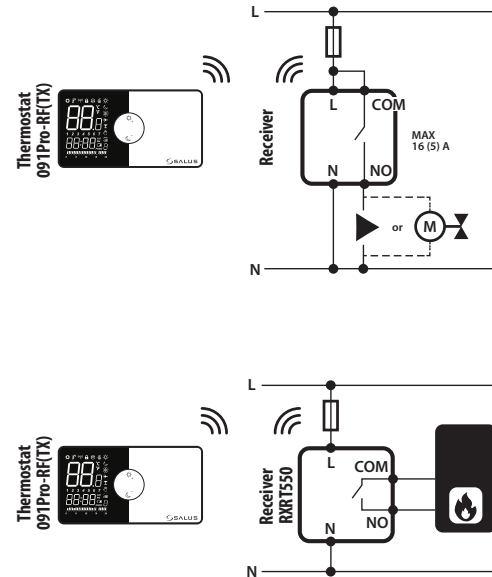

First Power Up

The thermostat and receiver come pre-paired from the factory, so no setup is needed.

Once you turn on the thermostat and receiver, they will pair automatically.

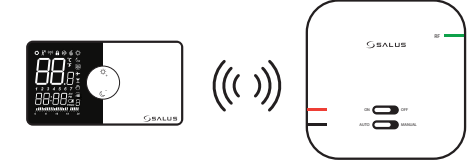

Time & Date Adjustment

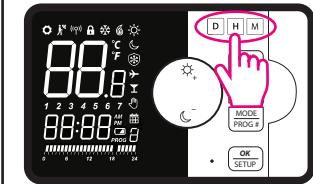

Press the **D**, **H** and **M** buttons to set the day, hour, and minute.

Change Setpoint Temperature



Press the **TEMP BACK** button.

Press **☾** or **☀** buttons to adjust setpoint temperature. Press **OK SETUP** to confirm.

Mode Selection

Mode selection allows users to cycle through different operating modes of the 091PRO RF, each tailored for specific situations.

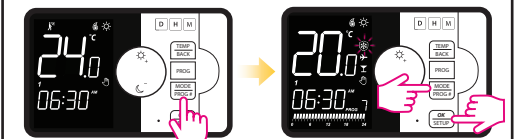
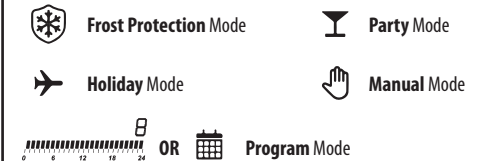

Press the **MODE PROG #** button to open **Mode Selection**.

Press **MODE PROG #** to cycle through modes, then **OK SETUP** to confirm.

Frost Protection Mode

Frost protection prevents the temperature from dropping below a safe level, helping to avoid freezing temperatures and maintain minimal heating when the system is off.

How to adjust Frost Protection temperature.

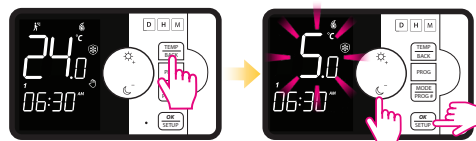

Press the **TEMP BACK** button.

Press **☀** or **☾** buttons to adjust setpoint temperature. Confirm by selecting **OK SETUP**.

Holiday Mode

Holiday mode keeps the thermostat at a set temperature for an extended period while you're away, helping to save energy while preventing the home from getting too cold or too hot.

After selecting Holiday Mode:

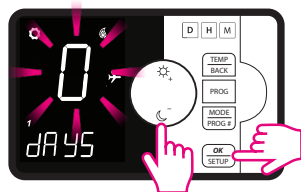

Press **☀** or **☾** buttons to adjust the number of days active. Confirm by selecting **OK SETUP**.

Party Mode

Party mode temporarily overrides the scheduled temperature for a set number of hours, ensuring comfort during gatherings without changing the regular schedule.

After selecting Party Mode

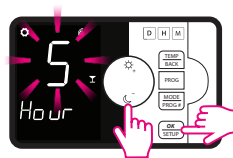

Press **☀** or **☾** buttons to adjust the number of hours active. Confirm by selecting **OK SETUP**.



Thermostat will start the Party Mode countdown.

Manual Mode

Manual mode allows users to set and maintain a desired temperature without following a schedule. The setpoint can be adjusted anytime.

After selecting Manual Mode

From main screen it can be selected one of the two settings by pressing button with the same icon:

- **Comfort mode** ☀ - maintains a higher set temperature for a warm and cozy environment, ideal for times when you are at home and active.
- **Economic mode** ☾ - maintains a lower set temperature to save energy while still keeping the space comfortable, ideal for times when less heating or cooling is needed.

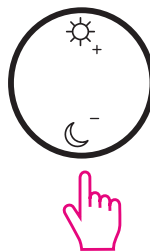

The user can set custom temperatures for both **Comfort** and **Economic** modes to match their personal preferences.

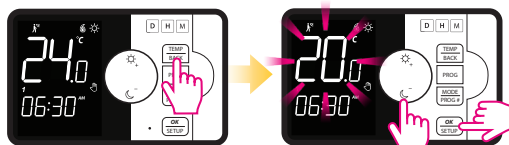

Press the **TEMP BACK** button.

Press **☀** or **☾** buttons to adjust setpoint temperature. Confirm by selecting **OK SETUP**.

Program Mode

Set up your personalized heating schedule or use a preset one to match your daily routine. Define different temperature settings for specific times of the day, ensuring comfort and energy efficiency. Once programmed, the thermostat will automatically adjust the temperature according to your schedule.

There are two programming modes that can be used:

Hourly program

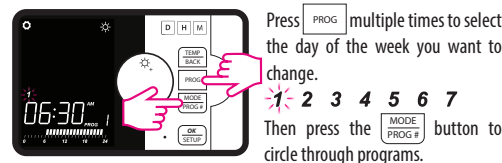

Press **PROG** multiple times to select the day of the week you want to change.

Then press the **MODE PROG #** button to circle through programs.

The thermostat offers 9 programs in total. PROG 0–5 are factory preset and cannot be edited, but you can select and use them. PROG 6–8 are customizable, allowing you to create your own heating schedule.

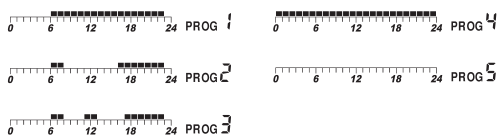

How to personalize a program:

When reaching a program that can be personalized, use the **☀** and **☾** buttons to select if you want to use the **Economic** or **Comfort** Mode. Selection should be done by circling through all hours.

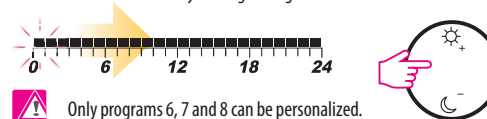

Only programs 6, 7 and 8 can be personalized.

Confirm by pressing **OK SETUP** button.

Personalized time intervals

Press **PROG** to select the days of the week you want to change and circle through options by **☀** and **☾** buttons.

- Full week: **1 2 3 4 5 6 7**
- Weekend: **6 7**
- Working days: **1 2 3 4 5**
- Individual days

Continue by pressing **OK SETUP** button.

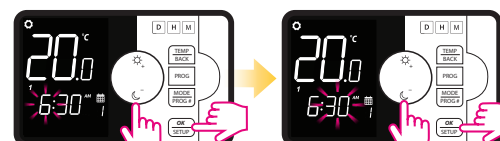

Set the hour by using **☀** and **☾**. Then confirm by pressing **OK SETUP**.

Set the minute by using **☀** and **☾**. Then confirm by pressing **OK SETUP**.

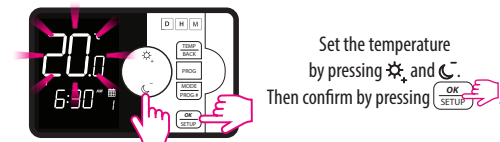

Set the temperature by pressing **☀** and **☾**. Then confirm by pressing **OK SETUP**.

There is a number of 6 programs for each day. This process repeats for all 6 programs. Once you finish setting one program, the next one will automatically appear for adjustment.

Please note: Each period's start time must be strictly between the start time of the previous period and the start time of the next one. This ensures a logical sequence and prevents overlapping or conflicting schedules.

Example:

- **1st Period:** 6:30, 20°C (1st period is active until 2nd period starts)
- **2nd Period:** 8:00, 24.5°C (2nd period is active until 3rd period starts)
-
-
-
- **6th Period:** 22:00, 20°C (6th period is active until 1st period of the next day starts).

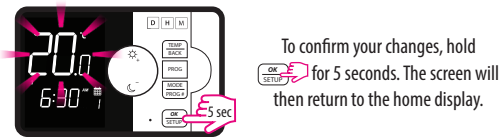

To confirm your changes, hold **OK SETUP** for 5 seconds. The screen will then return to the home display.

Other Settings

The thermostat also includes additional settings to customize your experience, allowing you to adjust preferences to suit your needs.



Hold the button **OK SETUP** for 5 seconds.

Press **☀** or **☾** buttons to select your preference. Confirm by selecting **OK SETUP**.

After confirming, the screen will cycle through all the options below:

Display	Description
HEAT	Allows the user to activate Boost Mode based on motion detection.
DISP	Allows the thermostat to turn on based on motion detection.
24h or 12h	24 or 12 hours format.
OFFS	Temperature offset adjustment: Range from -3.5°C to +3.5°C in 0.1°C steps, default set to 0.0°C.
TEST	Activates RF test mode for the receiver to check signal quality.
SYNC	Activates thermostat-receiver pairing. If select YES it will be open for 10 minutes
PIN	Allows the user to set a PIN for security.
SPAN	Sets the temperature range before heating or cooling turns on/off.
DLY	Enables a 5-minute heating switch delay (heat mode only).
Lo	The lowest temperature that can be set.
Hi	The highest temperature that can be set.
REC	When set to NO, the receiver works only in Auto mode, ignoring manual controls. Default: YES.

Hold again the button **OK SETUP** for 5 seconds to exit settings mode.

Factory reset



Press and hold for 10 seconds the **Factory Setup** button.

Select YES by pressing **☀** or **☾**. Then confirm by pressing **OK SETUP**.

