

3 X THERMOSTAT SMART HOME EL600F
1 X GATEWAY INTERNET UG800
1 X CENTRU DE COMANDA CB12RF

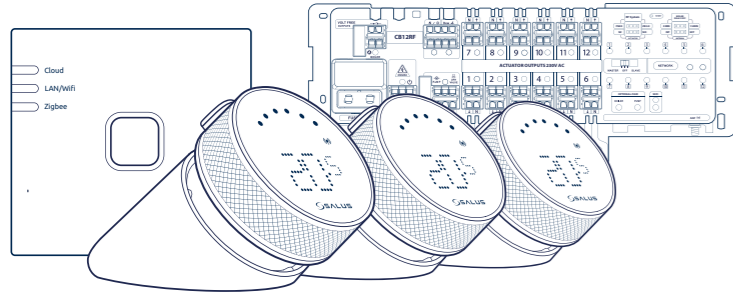

SMART HOME PACKAGE FOR UNDERFLOOR HEATING CONTROL

INSTALLATION MANUAL

Introduction

The 3-zone Smart Home package, consisting of a **UG800** gateway, a **CB12RF** control center, and three ultra-quiet **EL600F** thermostats, offers a complete solution for efficient and comfortable home heating control. This system allows for individual temperature management in each zone, giving users the ability to save energy and maintain an optimal indoor climate. Through the UG800 gateway, all devices are connected via ZigBee, enabling remote control via the **SALUS Premium Lite** app.

Important Note: To ensure the system operates correctly, the components must be installed in the following order: **Gateway UG800** → **Control Box CB12RF** → **EL600F Thermostats**.

Product compliance

This product complies with the essential requirements and other relevant provisions of the GPSR Directive 2023/988, the RED Directive 2025/138/EU, REACH SVHC 251, RoHS 2015/863/EU, and 2017/2102/EU amending Annex II to Directive 2011/65/EU of the European Parliament and of the Council on the restriction of the use of certain hazardous substances in electrical and electronic equipment. The full text of the EU Declaration of Conformity is available at the following web address: www.saluslegal.com

EL600F (p) 2405-2480MHz; <14dBm
CB12RF (p) 2405-2480MHz; <20dBm
UG800 (p) 2405-2480MHz;<20dBm (WiFi)

Safety Information

Use in accordance with national and EU regulations. Installation must be performed only by qualified personnel. For indoor use only. Keep the devices completely dry. The AC/DC adapter must be plugged into an outlet that is located near the device and is easily accessible. The gateway has an IP30 rating. Unplug the device before cleaning it with a dry cloth. The equipment is suitable only for installation at heights ≤ 2 m. The maximum ambient temperature is 50°C.

Package contents

- 1 x CB12RF Box (Control Box + Accessories)**
- CB12RF (Control Box)
 - Installation Manual
 - Power Cable
 - 4 x Screws
 - 4 x Wall Anchors

- 1 x UG800 Box (Coordinator + Accessories)**
- UG800 (Coordinator)
 - Installation Manual
 - Wall Mount Bracket
 - Power Cable
 - Internet Cable
 - 2 x Screws
 - 2 x Wall Mount Anchors

3 x EL600F Box (Thermostat + Accessories)

- EL600T (Thermostat)
- Installation Manual
- Charging dock
- Wall mounting plate
- Mini wall plate
- USB Type-C cable
- 2x M3x25mm screws
- 2x M3x15mm screws
- 2x Wall plugs
- Double-sided adhesive mounting

EL600F represents the code for the package that includes the thermostat, while **EL600T** is the code for the thermostat itself.

1. GATEWAY UG800



Scan here for the product installation guide

Factory reset

Resetting the UG800 gateway to its factory settings will erase all settings and associated devices from its memory. To do this, use a paperclip or a pin to press and hold the button for about 10 seconds, until all LEDs turn orange, then release it.

Description of LEDs

	Cloud Solid green. When the device is connected to the Cloud.
	Cloud Solid orange. When the device cannot connect to the Cloud.
	LAN/WiFi Solid green. The gateway is connected to the router via LAN or Wi-Fi
	LAN/WiFi Solid red. The gateway is not connected to the router via LAN or Wi-Fi
	ZigBee Solid green. Closed ZigBee network.
	ZigBee Flashing green. Identification.
	ZigBee Solid orange. Open ZigBee network (search for and add devices)
	ZigBee Flashing orange. When the maximum number of allowed devices has been exceeded.

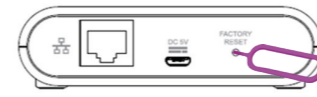

10 sec

Online:

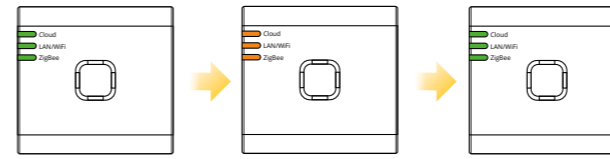

Offline:

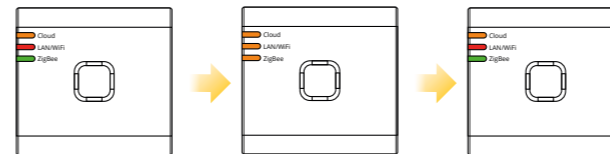

2. CB12RF CONTROL BOX



Scan here for the product installation guide

Button functions

The CB12RF is a smart wireless control box designed to manage and simplify underfloor heating systems. It easily connects to compatible devices using IT600 and ZigBee 3.0 technologies, facilitating integration into a smart home system. Compact and easy to install, it can control multiple heating zones and supports up to two actuators per zone, making it suitable for a variety of heating requirements. With built-in Wi-Fi for remote access and updates, the CB12RF offers a reliable and efficient solution for controlling modern heating systems.

Important Note: The built-in Wi-Fi module of CB12RF control box is used exclusively for software updates in installations without a gateway (offline mode). Connection to the cloud and the app is only possible via a gateway (UG800/UG600).

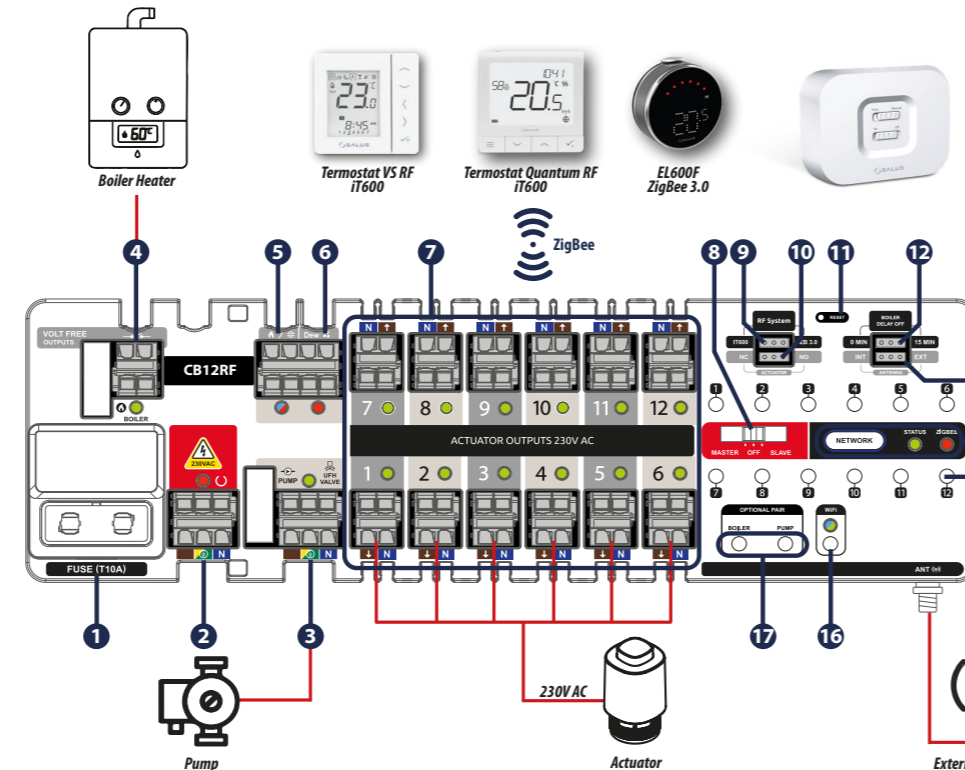

RX10RF & RX30RF Boiler Receiver (optional)

An additional wireless control module that can be used—for example—when it is not possible to run a cable between the CB12RF control unit and the boiler.

When using the CB12RF exclusively with EL600F thermostats, the UG800 gateway, and, optionally, the RX30RF receiver, jumper no. 9 must be set to position ZB 3.0.

When using the CB12RF with thermostats from the Quantum (SQ.) series, VS.. series, TS600 series, or other compatible models from previous generations, jumper no. 9 must be set to the IT600 position.

When jumper no. 9 on the wiring centre is set to ZigBee 3.0 mode (ZB 3.0), one EL600F thermostat can be paired with a maximum of 8 zones. When jumper no. 9 is set to the IT600 position, one thermostat can be paired with all 12 zones of the wiring centre.

When the CB12RF is configured in IT600 mode and used in online mode, the RX30RF receiver operates in the same way as the RX10RF.

Please note: In order for the CB12RF to be able to connect to the network, ensure that slide switch no. 8 is set to SLAVE before proceeding with the installation.



- 1 Fuse
- 2 Power supply
- 3 230V pump output
- 4 Central output (potential-free)
- 5 Heating/cooling switch
- 6 Dew point (for detecting condensation)
- 7 Control Box's heating zones
- 8 Selection MASTER - OFF - SLAVE
- 9 Jumper IT600 - ZigBee 3.0
- 10 Select actuator NC-NO
- 11 Reset button
- 12 Boiler delay selection 0 MIN - 15 MIN
- 13 Antenna selection INT - EXT
- 14 Network buttons and LEDs
- 15 Zone buttons
- 16 WiFi Button and LED
- 17 Buttons for the boiler and pump

3. EL600F Thermostat



Scan here for the product installation guide

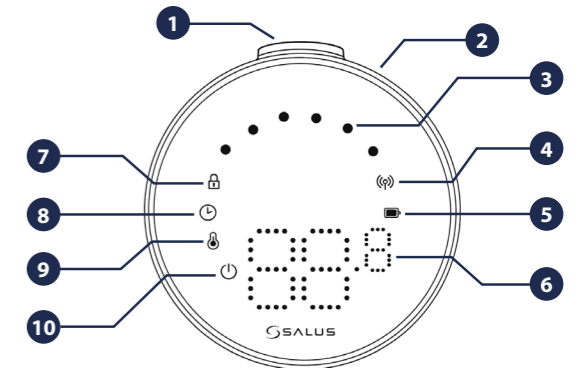

- 1. Button
- 2. Rotary selector
- 3. Heating/cooling mode indicator
- 4. RF status
- 5. Battery status
- 6. Temperature display
- 7. Locked mode
- 8. Program settings
- 9. Mode Setting/Optimum features
- 10. Frost protection (off mode)

Before commencing the installation:

The Elypso EL600T thermostat is partially charged; however, we recommend that you fully charge the battery before use. Connect the charger to the USB-C port located on the back of the charging station to charge the device.

It may take approximately 24 hours to fully charge the battery.

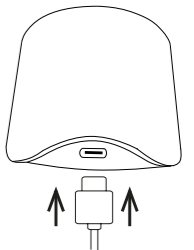

Proper positioning

The ideal location for installing the thermostat is approximately 1.5 meters above floor level and away from sources of heat and cold. The thermostat should not be exposed to direct sunlight or extreme conditions, such as drafts.

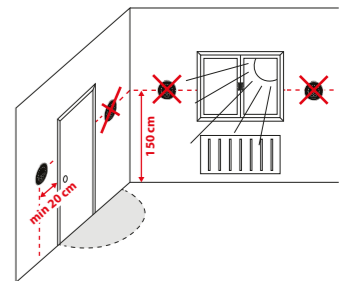

Manufacturer:
SALUS Controls plc
Units 8-10, Northfield Business Park,
Forge Way, Parkgate Rotherham, S60 1SD, UK

Importer:
Salus Controls
European Distribution spz o.o. ul. Szamocka 8,
piętro 6. 01-748 Warszawa, Poland

Email: tech@salus-tech.com

www.saluscontrols.com



SALUS Controls is a member of the **Computime Group**. Maintaining a policy of continuous product development, SALUS Controls plc reserves the right to modify the specifications, design, and materials of the products listed in this brochure without prior notice.



ONLINE INSTALLATION - USING AN ETHERNET CABLE

(with an internet connection via the SALUS Premium Lite app)



Once the gateway has been turned on and connected to the router, wait until all the LEDs turn green.

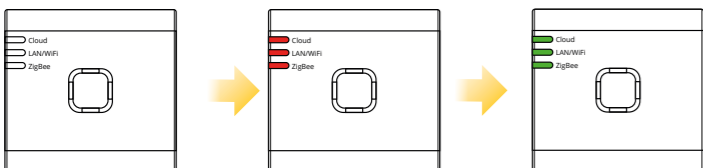

Note: The UG800 can also connect to the internet wirelessly via Wi-Fi. To set it up, use a smartphone with Bluetooth enabled (see the UG800 quick start guide).



This product must be used with the SALUS Premium Lite app. Scan the QR code above to install the app.

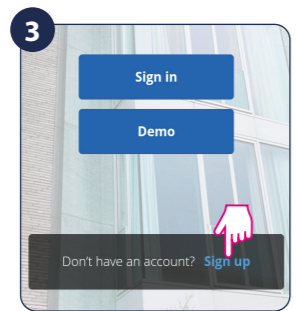

Optional: If you do not have a SALUS Premium Lite account, select the registration option and add the required details.

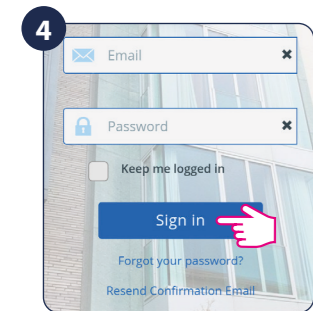

Log in to your SALUS Premium Lite account.



Activate your gateway to begin using your devices.

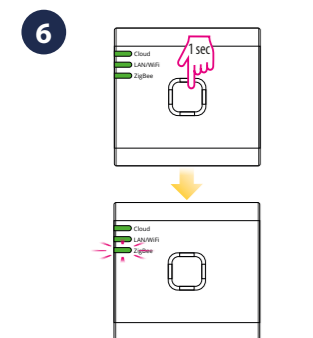

Note: The UG800 can also connect to the internet wirelessly via Wi-Fi. In this case, select "Connect via Wi-Fi".

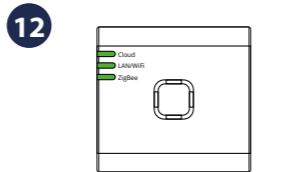
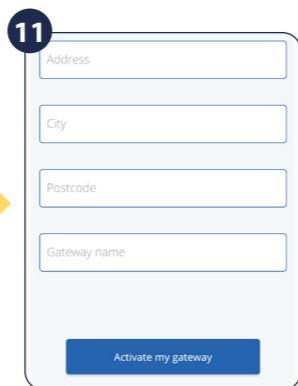
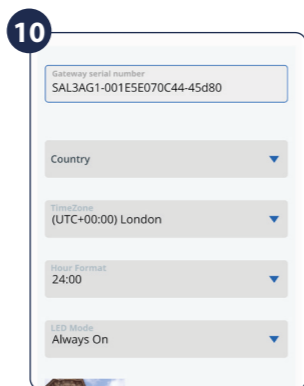
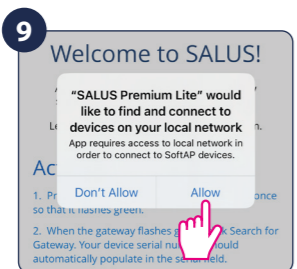

Once the gateway has been activated, the app will automatically return to the home screen, and the three LEDs on the gateway will glow green steadily.

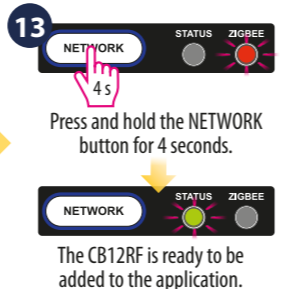

Press and hold the NETWORK button for 4 seconds.

The CB12RF is ready to be added to the application.



Select the menu button from top right side of the screen.

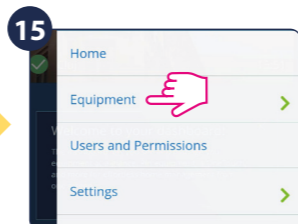

Select Equipment.

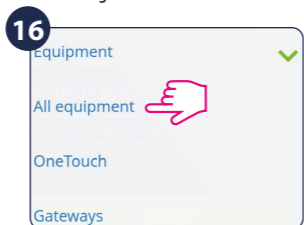

From the menu select All equipment.

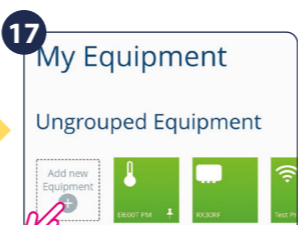

Select Add new Equipment.

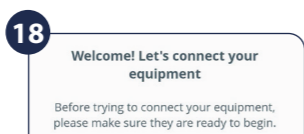

Scan for equipment.

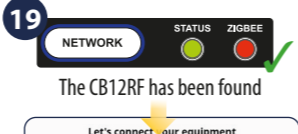

The CB12RF has been found.

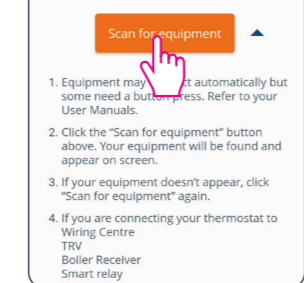

Select Connect equipment.

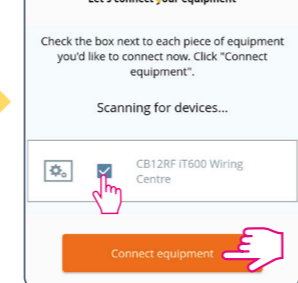

Select Finish.



Rename this equipment

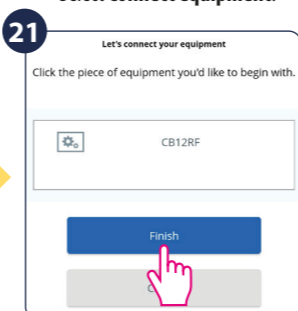

Select Finish.

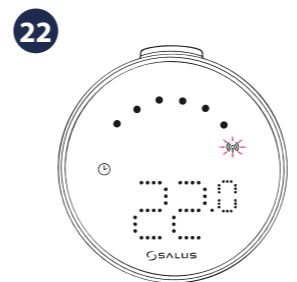

Make sure the thermostat is turned on and that the RF signal indicator is flashing.

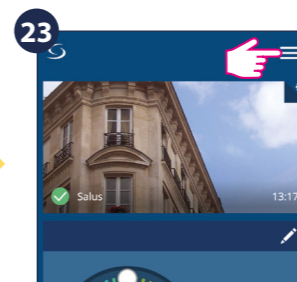

Tap the menu icon in the upper-right corner.

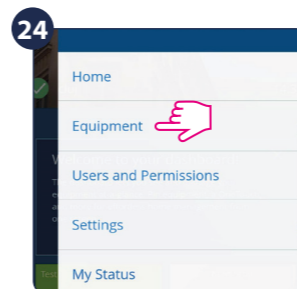

Select Equipment.

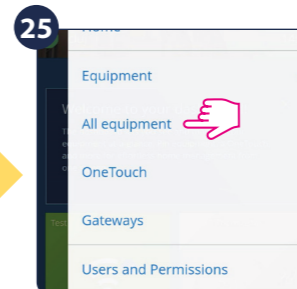

From the drop-down menu, select All Equipment.



On the Groups tab, select Add New Equipment.

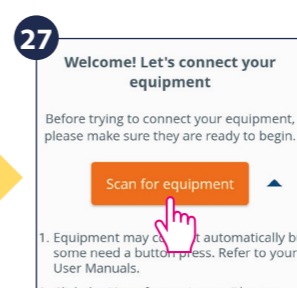

Scan for equipment.

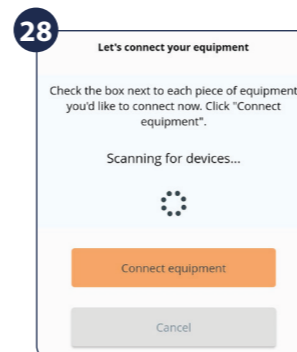

The app will scan for devices.

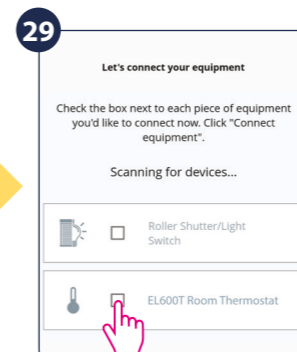

Check the box to select "EL600T Room Thermostat".

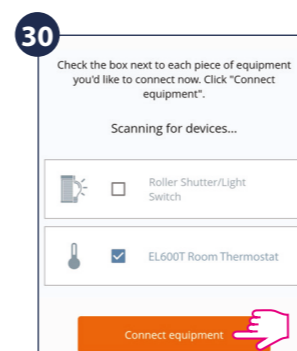

Connect the equipment.

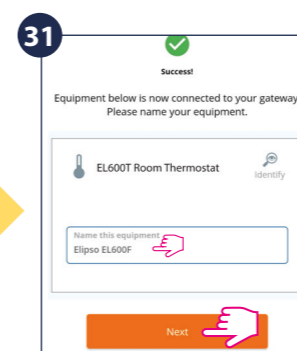

Name this equipment.

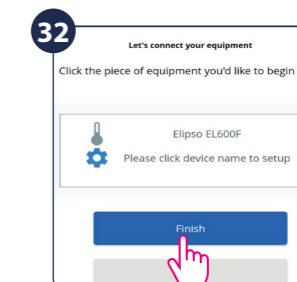

Tap "Finish" to return to the dashboard.

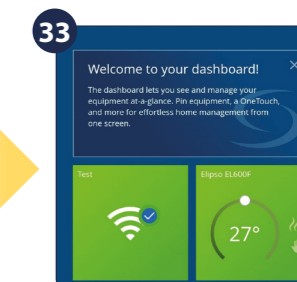

The thermostat has been added to the dashboard.

Pairing the thermostat with a specific zone

In online mode, all compatible thermostats can be linked to the same control center.



Select the thermostat.

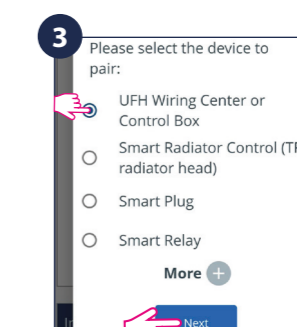
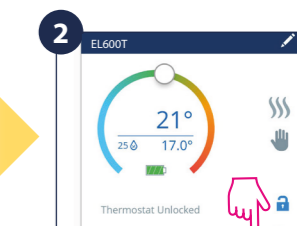

Please select the correct Underfloor heating Wiring Center or Control Box from the below list.

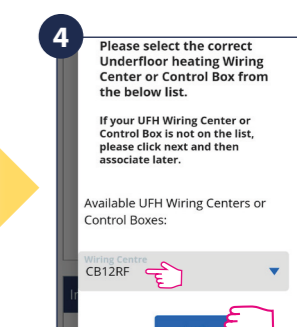

Select CB12RF.

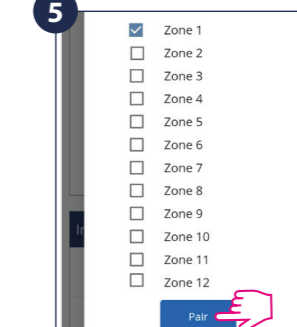

Match with the desired area(s).

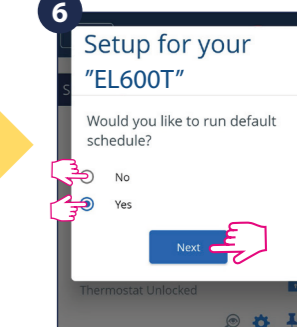

Confirm whether you want to use the standard program.

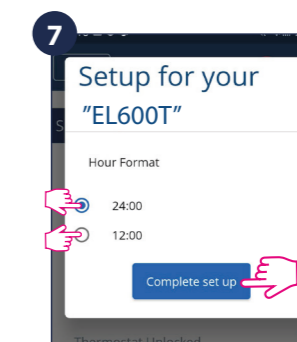

Select the time format.

