

SALUS Sense

Ai Feature within the SALUS Premium App



Unlock your Potential!

User Manual

SALUS Sense Unlock your Potential!

Introducing **SALUS Sense**, the new AI-powered feature within the **SALUS Premium Lite app** that transforms the way you manage home heating. SALUS Sense learns from your heating control habits and uses real-time outdoor weather data, supplied via IBM's weather data API, to intelligently adjust a range of SALUS products, maximising comfort while reducing energy consumption. Backed by real-world testing, it has been proven to deliver significant savings across both **HVAC and underfloor heating systems**. The app provides easy-to-read reports on your savings and offers personalised tips to help you save even more. **Download the SALUS Premium Lite app today and unlock SALUS Sense** to start cutting costs and using energy smarter.

SALUS Sense is only available to use with the following thermostats:
VS10, VS20, EL600F, SQ610, SQ610B, SQ610RF and SQ610BRF.

Step 1 - Download the app

To start using SALUS Sense, you will need the SALUS Premium Lite app. If you don't already have it, please scan the QR code below and download from either the App Store or Google Play.

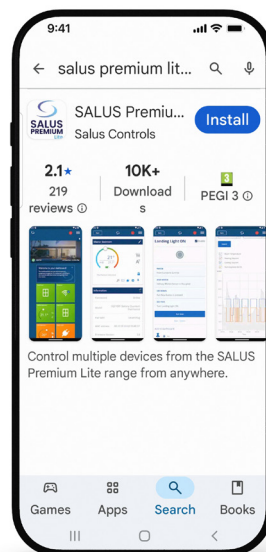

Step 2 - Subscription

SALUS Sense is an advanced feature within the app. Pop-ups will notify you that you are eligible to use this feature. Press on the "Got it", then press "Subscriptions" and then press "Subscribe Now".

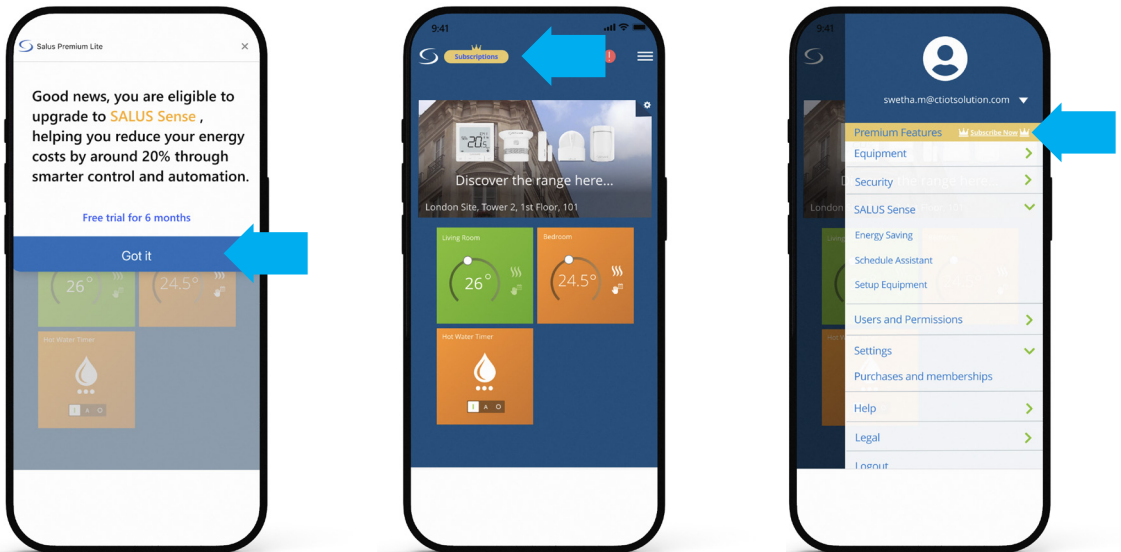

You will be given a free 6 month trial period from the date of sign-up and you will be given two options to choose from for your trial period. Either a 1 Gateway package or an upto 10 Gateways package paid Monthly or Annually allowing up to 12 thermostats to be added to each Gateway.

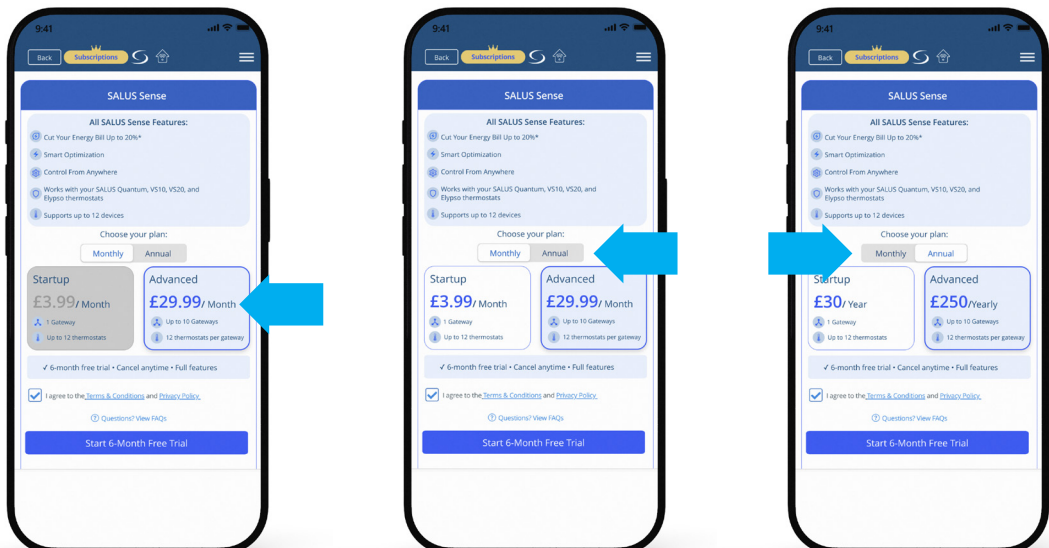

Step 2 - Subscription Continued

Depending on your subscription, the app will allow you to add up to 10 Gateways.
You can then click on the  button to add up to 12 thermostats per Gateway.

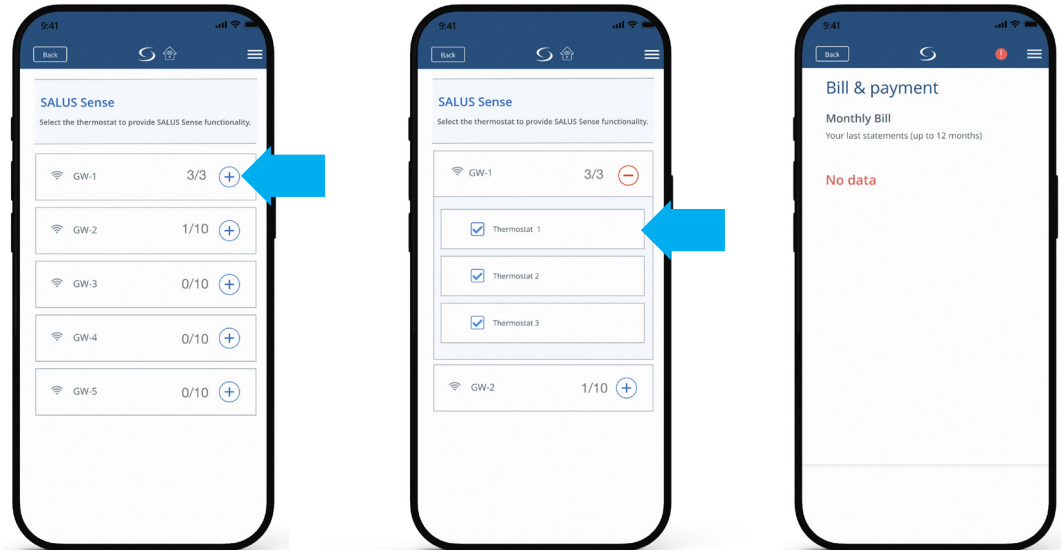

You can check and manage your subscription by going into Account subscriptions and manage subscriptions.
There you will see the active subscriptions and you can then make any changes you want to, including changing the plan, payment method or cancelling the subscription. You will see either a SALUS Sense or a Professional Monitoring account.

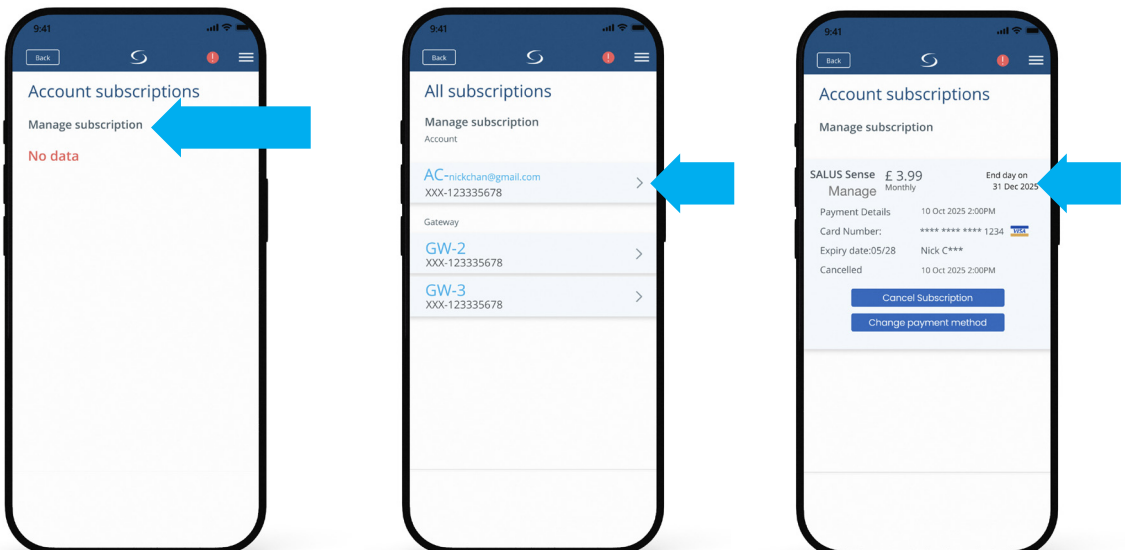

Step 2 - Subscription Continued

Here you can add or change your payment method. Select the plan you would like to change to. It will tell you how long you have remaining on your current plan. Then click Confirm Plan Change.

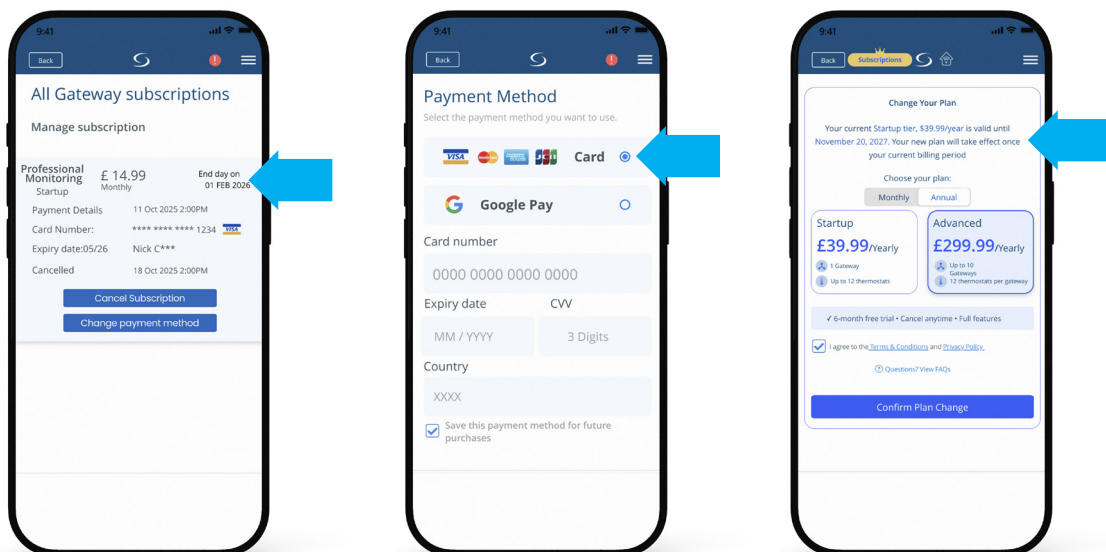

If you cancel your current plan you will see the screen below advising you of how long remains on your plan until it actually cancels. You can resubscribe at any time. If you click on the Cancel Subscription button you will see a screen giving you the options to confirm cancellation, change the plan or restore purchases.

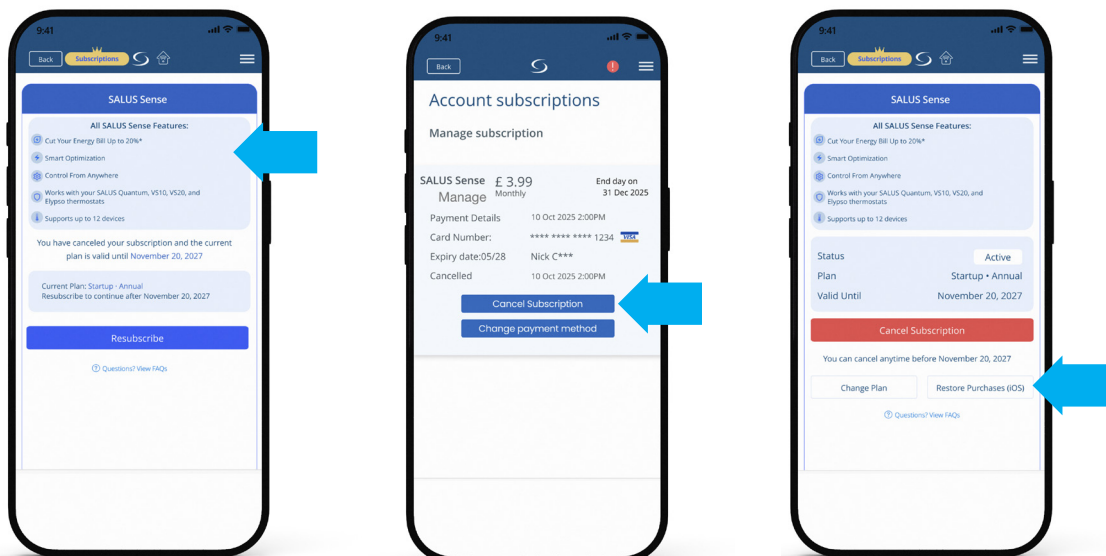

Step 2 - Subscription Continued

You can check your monthly statements from within the App. You will see the account name and plans associated with it. You will then see a breakdown of bill.

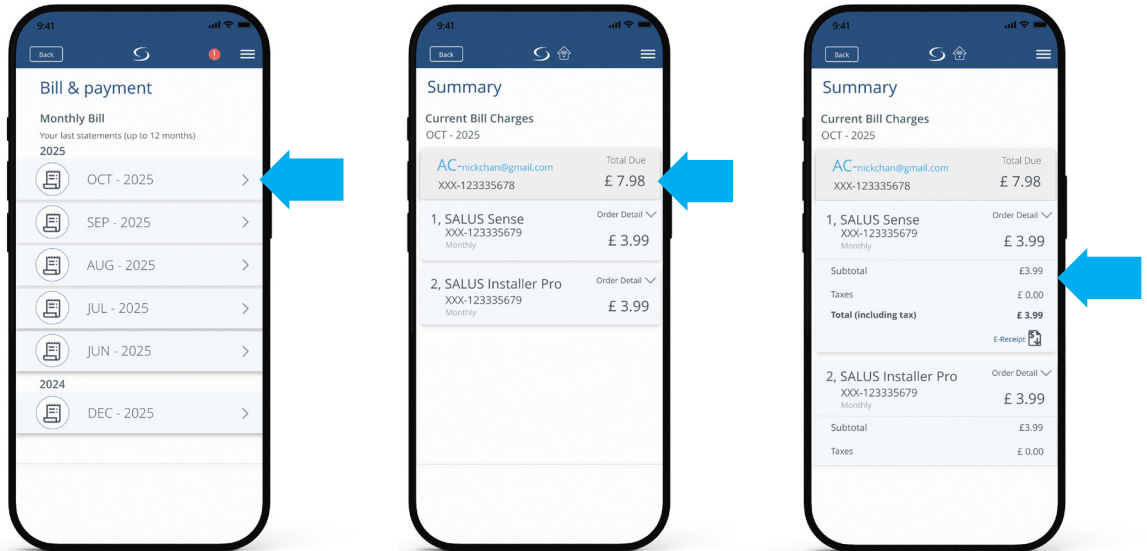

You will now see that the trial period is active, click on SALUS Sense to see the details of your Plan and press the button to add your Gateway and Thermostats.

PLEASE NOTE

If you choose to unsubscribe from SALUS Sense, your devices will remain connected until the end of your current subscription period. You will continue to have access to SALUS Sense on those devices until that time. If you no longer wish to use SALUS Sense with specific devices, you can disable or deselect the thermostats or gateways in the app.

Step 2 - Subscription Continued

Once you are happy with and confirmed your plan selection, double click the side button on your phone to pay and then OK. If you wish to see details of your subscriptions currently active in the Salus Premium Lite App log into your Apple Account.

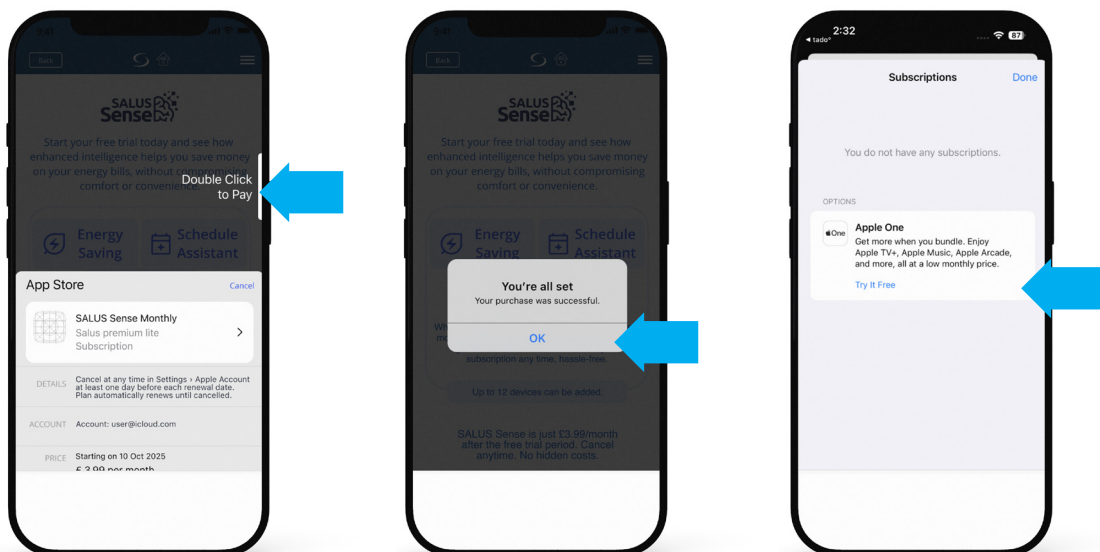

Here you can see the subscription and view your plans. You also have the option to cancel your free trial from this area.

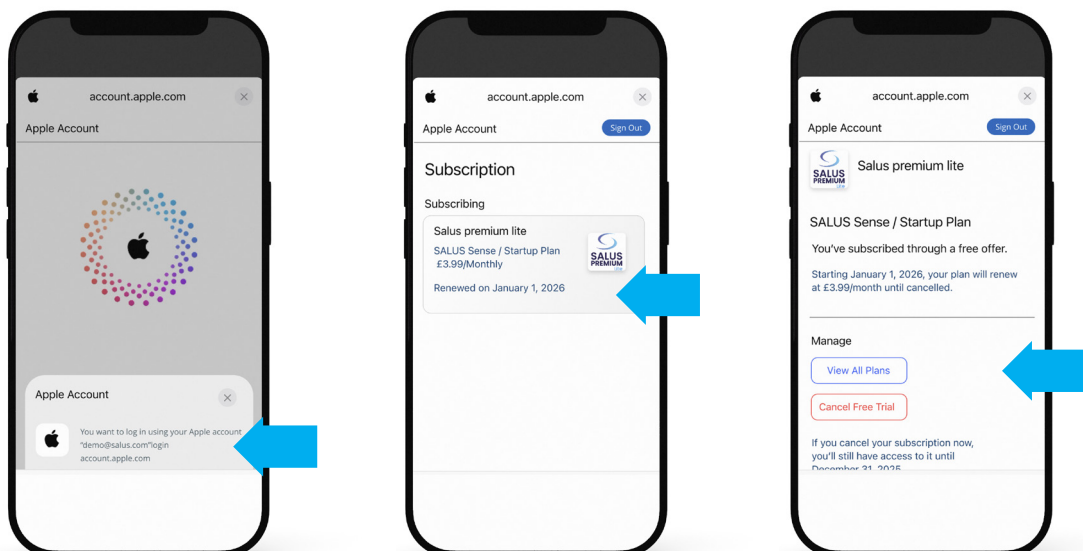

Step 3 - Energy Saving

On the home screen within the SALUS Premium Lite App click on the hamburger icon. Then click on Energy Saving to start using this function. Click on the arrows to scroll through the months.

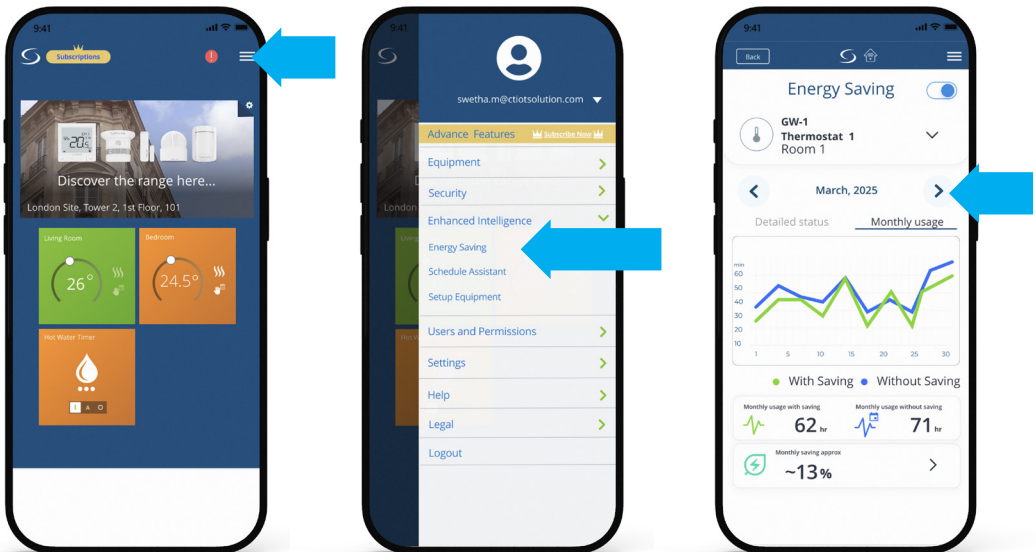

To find out the savings on a particular thermostat, select the gateway that it is associated with and then click on the pencil icon next to that thermostat. You will be shown a detailed status for the month shown, click the arrows to scroll through the months. If you want a months usage overview, click on Monthly usage.



Step 3 - Energy Saving

To see notifications regarding energy savings, turn on notifications within the SALUS Premium App. You will then receive pop-up notifications on savings made on various thermostats being monitored.

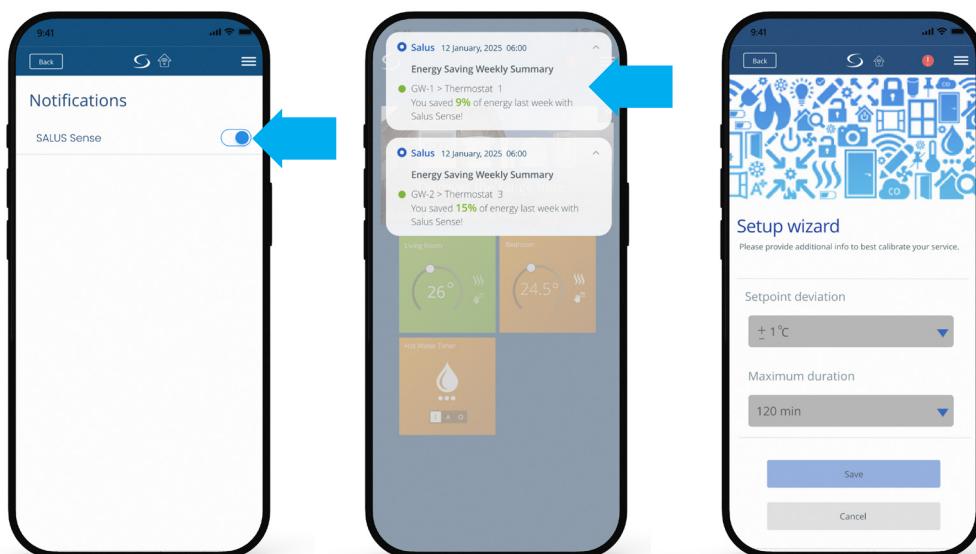

If Schedule Assistant is on SALUS Sense will adjust your schedule automatically to save energy. You can then compare current usage with previous usage.

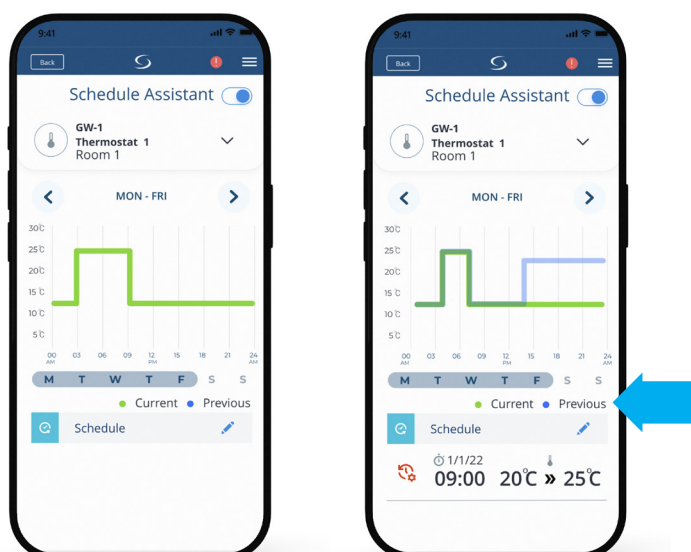



Available
within...



Salus Controls, Unit 10, Forge Way, Parkgate, Rotherham S60 1SD
Tel: 01226 323961 | www.saluscontrols.com