

## WIFI ADAPTER MODULE FOR INVERTER

Model: IW10



MULTI-LANGUAGE  
MANUAL



Quick Guide



### HEAD OFFICE

SALUS Controls, Units 8-10,  
Northfield Business Park,  
Forge Way, Parkgate  
Rotherham, S60 1SD

SALUS Controls GmbH,  
Dieselstrasse 34,  
63165 Mühlheim am Main,  
Germany

UK: tech@salus-tech.com  
DE / NL: info@salus-controls.de  
FR: technicalsupport@saluscontrols.fr  
RO: tehnic@saluscontrols.ro  
DK: Support@salus-controls.dk

INPUT: AC 100 - 240V, 50 - 60Hz, 0.3A  
OUTPUT: 5.0V  $\approx$  1.0A, 5.0W

www.saluscontrols.com



SALUS Controls is a member of the Computime Group  
Maintaining a policy of continuous product development SALUS  
Protect which is made up SALUS Controls and Safe4 reserves the  
right to change specification, design and materials of products  
listed in this brochure without prior notice.



V05  
07/2025

### Introduction

The IW10 WiFi Adapter Module is an advanced connectivity solution designed specifically for inverters, enabling seamless remote monitoring and control of your system via a wireless network. This compact and easy-to-install module allows users to connect their inverter to a local WiFi network, providing real-time access to performance data, status updates, and system diagnostics through a user-friendly mobile app or web interface. Whether you're at home or on the go, the IW10 ensures that you have complete oversight of your inverter's operation, helping to optimize performance, increase energy efficiency, and quickly address any issues that may arise.

This guide will take you through the setup process, key features, and essential usage tips, ensuring a smooth and hassle-free experience with your IW10 WiFi Adapter Module.

### Product Compliance

This product complies with the essential requirements and other relevant provisions of Directives 2014/30/EU, 2014/35/EU, 2014/53/EU and 2015/863/EU. The full text of the EU Declaration of Conformity is available at the following internet address: [www.saluslegal.com](http://www.saluslegal.com).  
( $\varphi$ ) 2405-2480MHz; <20dBm (WiFi).



### Safety Information

It is important to use the IW10 WiFi Adapter Module in accordance with all applicable regulations to ensure both safety and performance. This device is intended for indoor use only and should not be installed in outdoor or exposed environments where it may encounter moisture, extreme temperatures, or other external elements. Always keep the device completely dry, exposure to liquids could cause damage or malfunction. When cleaning the device, always disconnect it from power and use only a dry cloth to avoid introducing moisture.

Additionally, the IW10 module is designed to be installed at heights of 2 meters or lower to ensure easy access and safe operation. The maximum allowable operating temperature for the device is 45°C, so be sure to avoid placing it in areas that may exceed this limit to prevent overheating or damage. By following these guidelines, you will ensure the long-term functionality and reliability of the IW10 WiFi Adapter Module.

### Product description

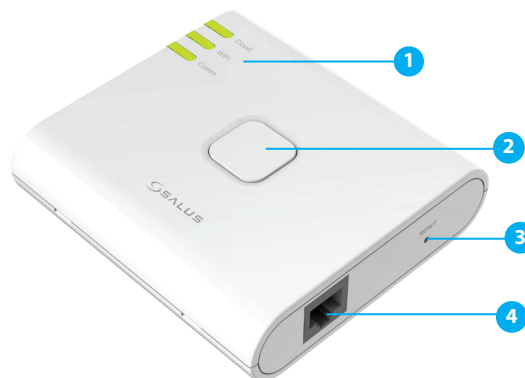

1. Cloud, WiFi, Comm LEDs  
2. SETUP button

3. RESET button  
4. RJ45 Ethernet port

### LED Signal & Status

LED Signal	Status
Cloud	- Dongle is connected to the cloud
WiFi	- Dongle is connected to the WiFi router
Comm	- Communication between the dongle and the inverter is correct
WiFi	- Dongle is in WiFi Setup mode
Cloud WiFi Comm	- Dongle is in Factory Reset mode
Cloud WiFi	- Firewall or Network Restrictions: Ensure no firewall is blocking the dongle's connection to the cloud. - Disable any firewall to stop connection to remote port 443 and 8443 - Check your Internet connection to any Website, e.g. <a href="http://www.bing.com">www.bing.com</a> - Check your broadband provider if the Internet is not working
Cloud	- Dongle is not connected to the cloud
WiFi	- WiFi Setup is not correct. - Possible reason: WiFi password is not correct
Comm	- Check the RJ45 plug, make sure the plug is fully inserted on the RJ45 socket. - Check the status of the Inverter, make sure the battery and main power supply is connected. - Contact the distributor of the Inverter for technical support.

Legend



Flashing Light



Solid Light

### Installation:



Installation: The mounting height is less than 2m  
The maximum operating temperature is 45°C.

To perform the installation, a cable with an RJ45 Ethernet connector on one end and a round aviation plug on the other will be used. This cable has the purpose to set the connection of the IW10 Dongle to the Single or Triple phase inverter.



### Cable with RJ45 and Round aviation plug



Note: Max. output of power supply source for WIFI Adapter module is less 15W

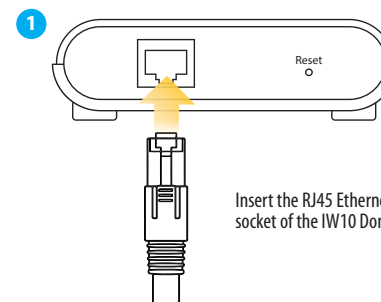

Insert the RJ45 Ethernet plug to the socket of the IW10 Dongle.

## 2 SINGLE PHASE INVERTER

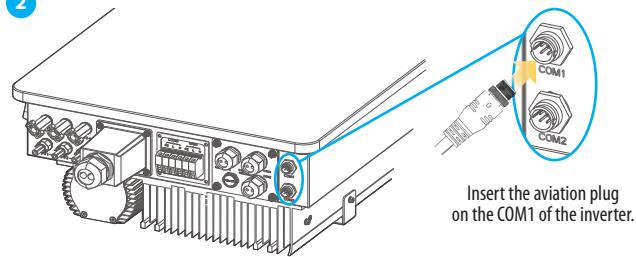

## TRIPLE PHASE INVERTER

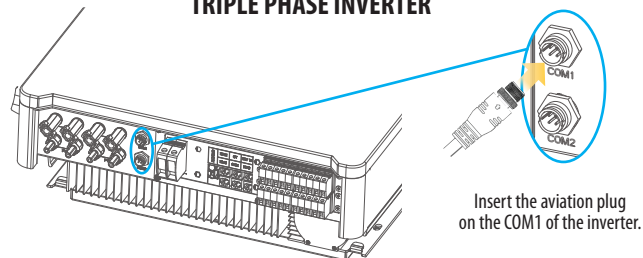

3 Make sure that you have downloaded the SALUS Premium Lite App from the Google Play or App Store.

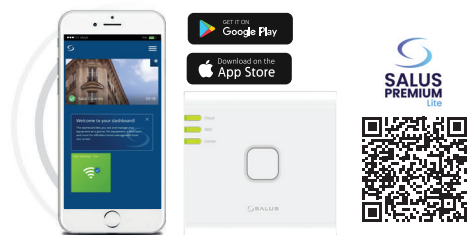

⚠ To discover and add devices, and to access all features, please ensure that the SALUS Premium Lite app has all necessary permissions (e.g. location and Bluetooth).

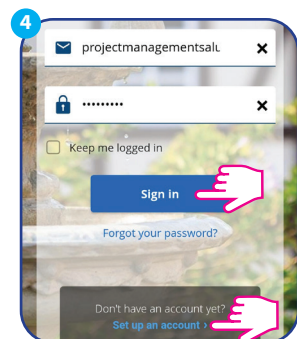

Sign in or create an account.

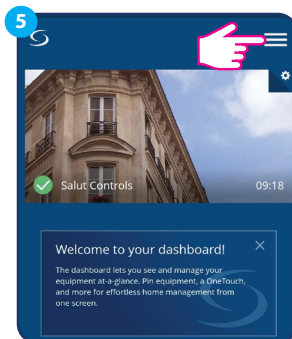

Select the top-right **Menu** option.

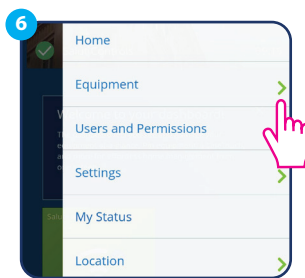

Select **Equipment**.

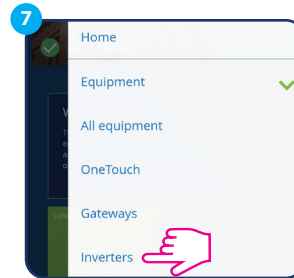

Select **Inverters**.

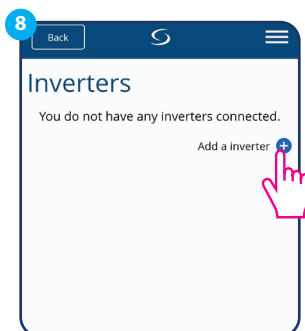

Select the **Add an inverter** option.

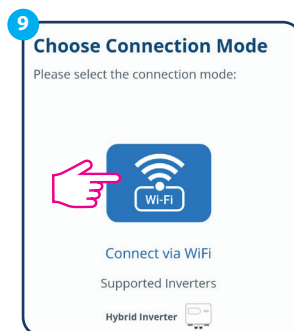

Select in **Connect via WiFi**.

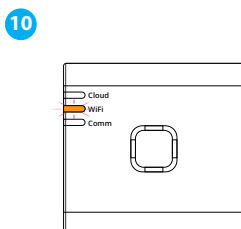

Make sure the WiFi adapter is powered on and searching for WiFi connection (WiFi Setup mode).

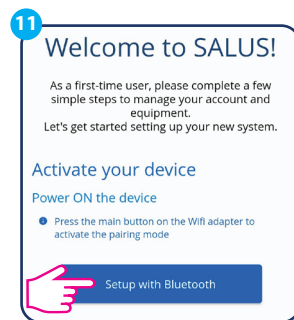

Select **Setup with Bluetooth**.

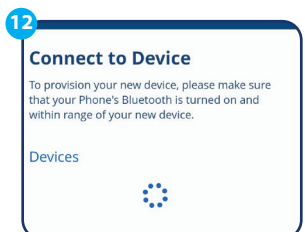

App is searching for devices.

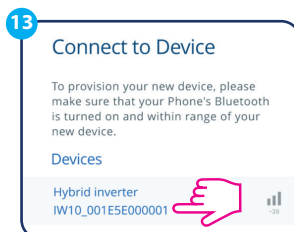

Select the Inverter.

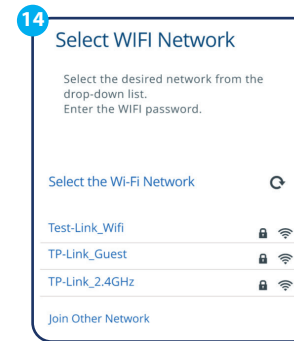

Select the WiFi network.

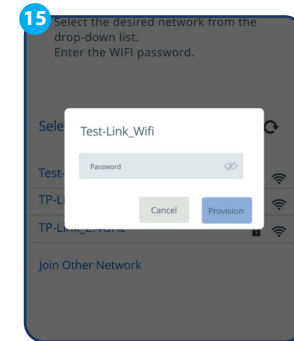

Provide the password.

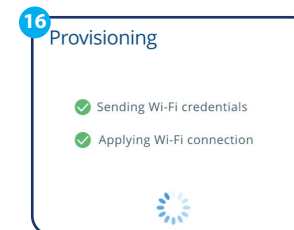

Wait for the connection to be established.

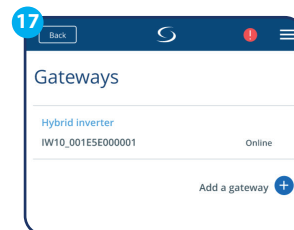

The inverter has been associated.

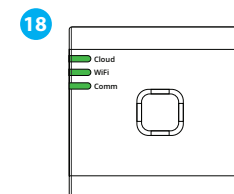

After successful setup, the 3 LEDs will be all green.

## SETUP Button & Functionalities

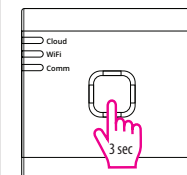

Press and hold for 3 seconds and release to enter WiFi setup mode

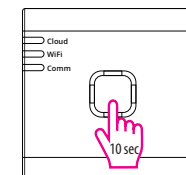

Press and hold for 10 seconds, three LEDs turn to orange, and release to conduct a factory reset

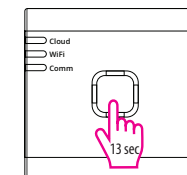

Press and hold for more than 13 seconds, return to normal mode, without any action.

## RESET button

Press and release to reset the dongle

ⓘ You need a needle to conduct the action press and release

