

Head Office:
SALUS Controls plc
SALLUS House
Dodworth Business Park South,
Whinby Road, Dodworth,
Barnsley S75 3SP, UK.
T: +44 (0) 1226 323961
E: sales@salus-tech.com



www.salus-controls.com

SALUS Controls is a member of the Computime Group
Maintaining a policy of continuous product development SALUS Controls plc reserve the right to change specification, design and materials of products listed in this brochure without prior notice.

For PDF Installation guide please go to
www.salus-manuals.com

Issue Date: August 2017
V01



SALUS[®]

CONTROLS

RXBC5V - RF Boiler Control



Installation

Pairing the RXBC5V



5. Connect the electrical plug.



6. Push fit boiler control into housing.
7. Power up the boiler and check the correct operation.



Press the "SYNC" button for 3 seconds
until LED starts flashing



The RXBC5V is ready to be paired
with your compatible SALUS device.

Note: Once paired please close the boiler control panel

Introduction

The RXBCSV boiler module 868MHz is a receiver with 5V DC to control ON/OFF of Boiler or other heat system via the RF signal transmitted from the thermostat.

Product Compliance

This product complies with the essential requirements and other relevant provisions of Directives (RED) 2014/53/EU and 2011/65/EU. The full text of the EU Declaration of Conformity is available at the following internet address: www.salus-controls.com.

(☐) 868MHz-868.8MHz; <13dBm

Safety Information

Use in accordance with the regulations. Indoor use only. Keep your device completely dry. Disconnect your device before cleaning it with a dry cloth.

Terminal connections

Terminal	Identifier	Description
1	DC +	DC power supply (+)
2	DC -	DC power supply (-)
3	COM	Common input
4	NO	Normal Open
5	NC	Normal Closed

Compatibility

The RXBCSV is compatible with the following SALUS products



RT310TX



ERT20TX



RT510TX



RT310iTX



iT500BM

Switch Position

- 1 The boiler receiver is off.
- 2 AUTO. RX will automatically receive the RF signal from your compatible SALUS device and controls relay output.
- 3 Manual mode - Manual Override (Note this mode will run your boiler continuously)

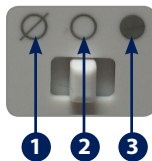

Installation

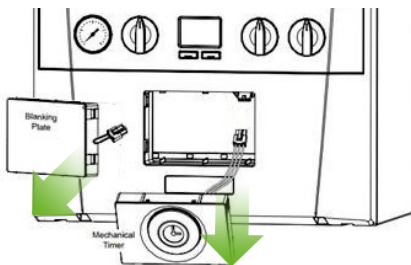

i Note: When removing blanking plate also remove visible thermostat link plug do not remove any internal link.

1. Ensure boiler is isolated and switched off.
2. Pull down control panel cover.
3. Remove existing mechanical timer and unscrew from plate.
4. Reverse the procedure to install the RXBCSV.

